

# Standard Retractor

## Product Parts

- 1 - Base
- 1a - Base Lid
- 1b - Base Snap Rail
- 1c - Base End
- 2 - Shock Corded Telescoping Pole
- 3 - Top Banner Rail
- 4 - Pin

**\*Do Not Pull Pin Until Directed**



## Banner Install

### Step 1

Remove all parts from the bag and place on a clean workspace. Open the Base Lid (1a) to locate and open the Base Snap Rail (1b).

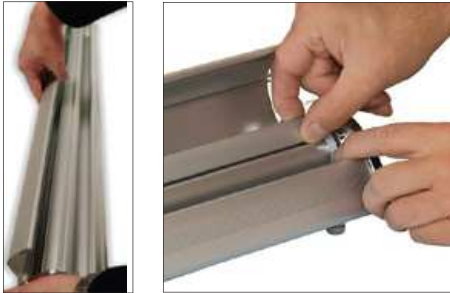

### Step 2

With your graphic face down, carefully feed the bottom of the graphic into the Base Snap Rail (1b). Press the Base Snap Rail (1b) down firmly to secure the banner into the Base (1).



### Step 3

Remove both end caps (A) from the Top Banner Rail (3) and snap the Rail open. Fully insert the top edge of the Banner into the groove of the Top Banner Rail (3) and snap it shut (B). Replace end caps.



### Step 4

Remove the Base End (1c) to reveal the Pin (4). Firmly hold Base (1) and banner while removing Pin (4). Slowly allow banner to roll into the Base. Close Base Lid (1a).



### Step 5

Store the Pin in the Base End (1c) for future graphic Changes. Replace the Base End (1c)



## Display Set-Up

### Step 1

Turn the Base (1) upside down and rotate the foot so it is perpendicular to the Base(!) and set Base (1) upright.



### Step 2

Assemble the Shock Cord section of your Shock Corded Telescoping Pole (2) and place the pole into the base receptacle.



### Step 3

Lift the Banner Rail (3) up and attach it to the top of the Shock Corded Telescoping Pole (2).



### Step 4

To adjust the height of your retractor, open the telescoping clamp to raise and lower your banner height. Do not exceed 79" high. Close the telescoping clamp to secure your pole in place.

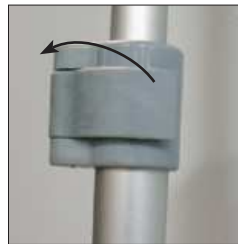

Flip open to adjust height



Close to secure



## Storage

Place all product parts into Carry Case and store in a cool dry location.



## Care

To clean, wipe with damp cloth.

*Warranty Information: All products are designed to provide the user with a cost-effective and durable product. Standard warranty is a 'one year parts and labor' warranty which warrants product against defects in material and workmanship. It does not cover damage due to accidents, abuse, or normal wear and tear. Products found to be defective will be replaced or repaired at factory's discretion.*