

Hybrid Pro 20x20 Modular Island Kit 29

HP-K-29

Hybrid Pro™ Modular Kit 29 is a modular 20ft x 20ft island exhibit kit that offers a plethora of features and a modern appearance. The center floor-based display is nearly 8ft tall and 8ft wide and includes three shelves on each side. A lockable door on the side of the center structure allows for accessible and secure storage. Triangular shaped fabric side walls offer a modern, angular look. Fabric graphics on the center structure are a combination of pillowcase fabric graphics (on the triangular side walls) and push-fit fabric graphics on the center walls. Two kiosks are included, which are similar in construction to the center display. Both kiosks offer four sides for graphic messaging, as well as three shelves for small product display. Counters shown are not included. Last but not least, a lightweight pill-shaped fabric structure caps the display for ample branding above eye level. No rigging required!

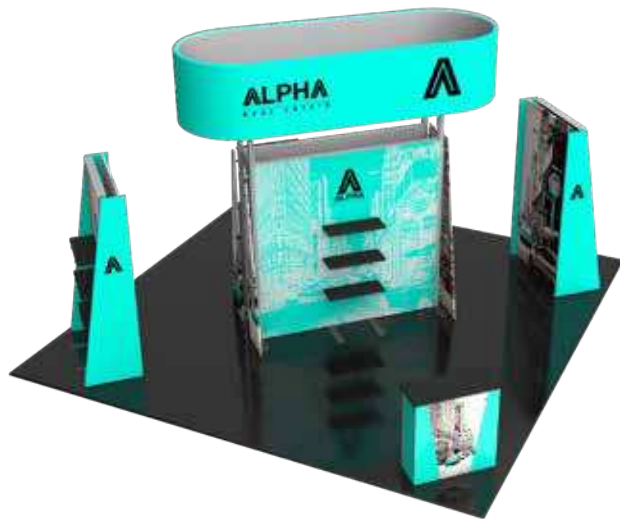

features and benefits:

- 12'4" tall island display
- No rigging required
- Center display includes four walls, two pillowcase fabric graphics and two push-fit fabric graphics, six shelves and a lockable door for storage
- Each kiosk includes four walls, two pillowcase fabric graphics and one push-fit fabric graphic, and three shelves for product display
- Pill shaped top fabric structure is tubular with pillowcase fabric graphics
- Each shelf can hold 15lbs
- Ships freight

dimensions:

Hardware	Graphic
<p>Assembled unit: 279.19" w x 149.96" h x 53.54" d 7091.43mm(w) x 3808.99mm(h) x 1359.92mm(d)</p> <p>Approximate weight: 634.46 lbs /287.79 kg</p>	Refer to related graphic template for more information.
Shipping	additional information:
<p>Packing case(s): N CRATE,FS CRATE</p> <p>Shipping dimensions:</p> <p>FS CRATE 90" w x 30" h x 36" d 2286mm(w) x 762mm(h) x 915mm(d)</p> <p>N CRATE: 60" l x 57" h x 48" d 1321mm(l) x 737mm(h) x 381mm(d)</p> <p>Approximate total shipping weight: 1008 lbs / 458.kg</p>	<p>Graphic material: Dye-sublimation zipper pillowcase fabric Dye-sublimation SEG push-fit fabric</p> <p>When included in a larger kit, a different packaging solution will be listed to accommodate all contents of the kit. Individual packaging no longer provided.</p> <p>Panel Colors:</p> <div style="display: flex; justify-content: space-around;"> <div style="text-align: center;"> grey</div> <div style="text-align: center;"> black</div> <div style="text-align: center;"> white</div> </div> <p>Tabletop Colors:</p> <div style="display: flex; justify-content: space-around;"> <div style="text-align: center;"> silver</div> <div style="text-align: center;"> black</div> <div style="text-align: center;"> mahogany</div> <div style="text-align: center;"> natural</div> </div> <p>3 person assembly recommended:</p> <div style="display: flex; justify-content: space-around;"> </div>

Setup notes

1. Redesign of this exhibit without approval by manufacture may result in dangerous and unsafe structures. Manufacture disclaims any responsibility for redesigned exhibits it does not approve in writing.

2. Parts and components such as panels and extrusions are manufactured to metric sizing. Where ever possible sizes have been noted in feet and inches as well as in metric. Below is the imperial to metric sizing table as a reference. 'Nominal' refers to approximate sizes.

IMPERIAL TO METRIC SIZES

8' Nominal = 94 1/2" or 2400mm Actual
4' Nominal = 47 1/4" or 1200mm Actual
3' Nominal = 35 7/16" or 900mm Actual
2' Nominal = 23 5/8" or 600mm Actual
1' Nominal = 11 13/16" or 300mm Actual

SIDE KIOSK X 2

Code	#	Description
A2	2	PHFC4-1200 EXTRUSION-WITH MITRE CUT FOR CB9-WITH MITRE CUT FOR CB9
SW-FOOT-500	2	SMART WALL FOOT 500MM LENGTH
CB9	4	90 DEGREE JOINER
A1	4	PHFC4-1200 EXTRUSION-WITH IB2 LOCK HOLE-WITH MITRE CUT FOR CB9
IB2	2	JOINER BAR(NEW DESIGN)



ASSEMBLE LAYING DOWN

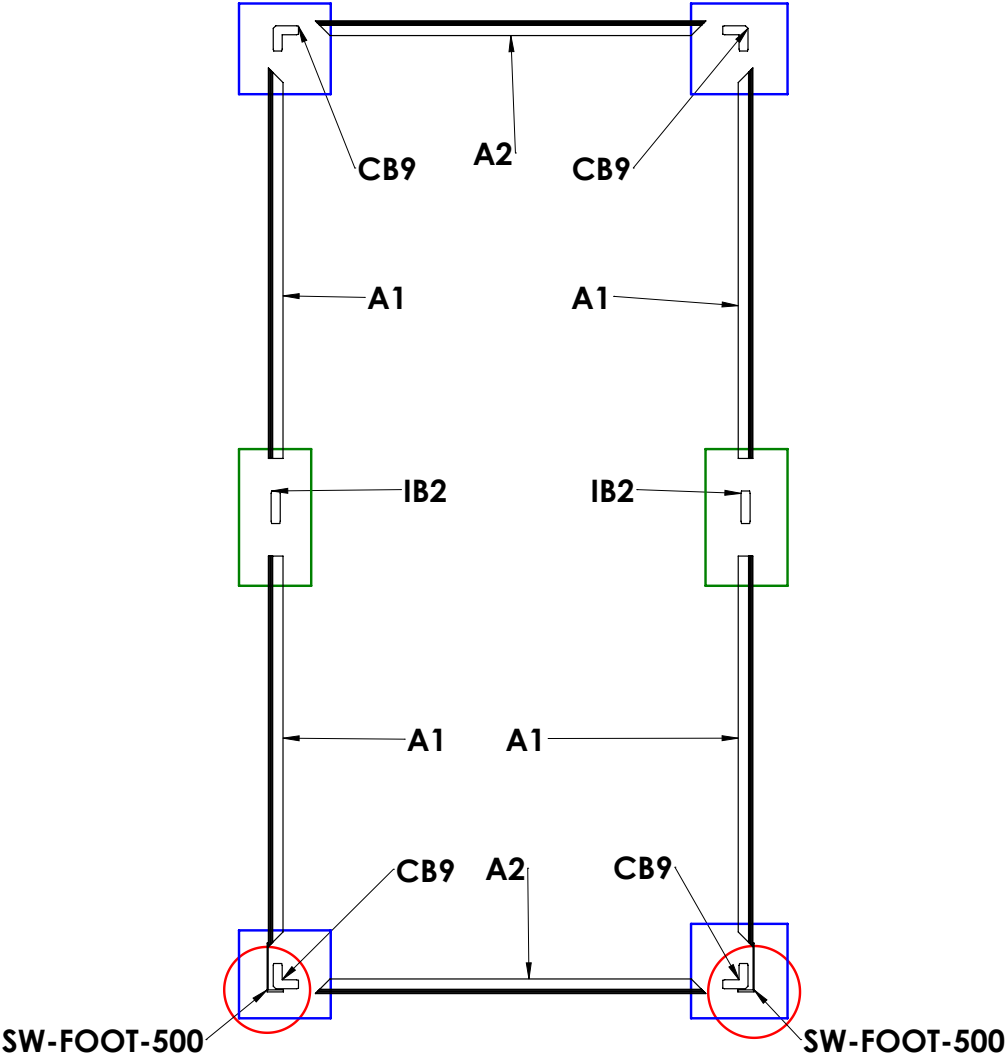
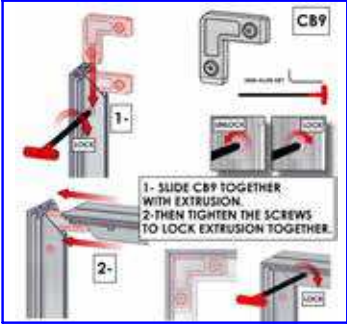

LABELING DIAGRAM FOR HP-K-29-A&B-SQU

SET UP INSTRUCTIONS:

1. CONNECT BOTTOM AND TOP TUBES FOLLOWING THE LABELS
2. CONNECT SIDE TUBES
3. CLEAN THE FRAME AND PLACE THEM ON CLEAN PLACE
4. CAREFULLY REMOVE FABRIC COVER FROM BAG
5. PLACE COVER AROUND THE BOTTOM OF THE FRAME
6. PULL COVER CAREFULLY UP TO THE TOP
7. CLOSE ALL ZIPPERS
8. ADJUST FABRIC AROUND THE FRAME
9. CONNECT CABLE HARNESS TO THE EYEBOLTS
10. COMPLETELY TIGHTEN THREADED CONNECTORS

ZIPPER ON BOTTOM OF BOTH

**HP-K-29-A
HP-K-29-B**



BREAK DOWN INSTRUCTIONS:

REVERSE SET-UP STEPS TO BREAKDOWN FRAME

FABRIC CARE INSTRUCTIONS:

1. UNZIP COVER ZIPPERS
2. CAREFULLY REMOVE FABRIC COVER
3. CLOSE ALL ZIPPERS
4. FOLD OR ROLL NEATLY
5. PLACE FABRIC IN COVER BAG

HP-K-29-A

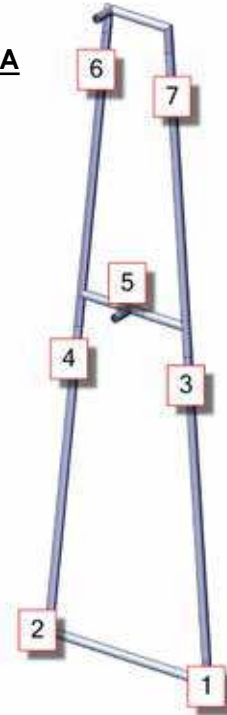

HP-K-29-B

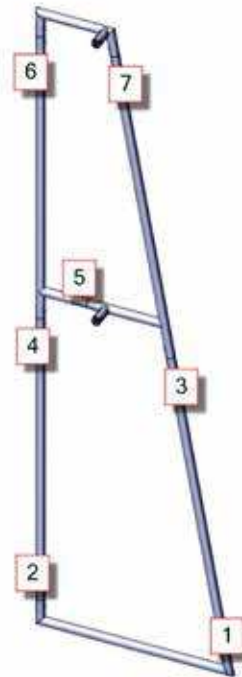

PARTS DIAGRAM

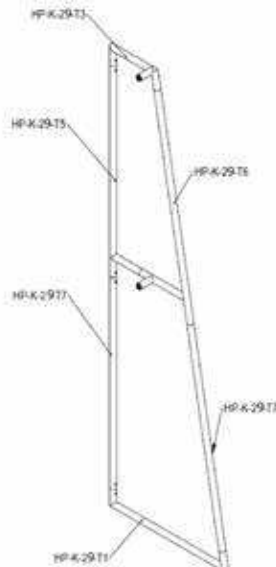

PARTS DIAGRAM

STEP #1:
SLIDE THE JOINER INTO THE TUBING SO THE HEX SCREW SITS IN THE HOLE ON THE TUBING

STEP #2:
TIGHTEN THE HEX SCREW SO THE JOINER SEPARATES AND TIGHTENS AGAINST THE INSIDE OF THE TUBING, LOCKING THE JOINER AND TUBING TOGETHER.

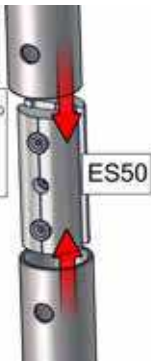

KIOSKS GRAPHICS

Code	#	Description
HP-K-29-G-G1	1	GRAPHIC(G1) 47.13 w X 94.37 h finished size Dye-sub print on 8oz. Power Stretch, with FCE-2 silicone beading sewn to back perimeter, corner pull sewn in bottom right corner
HP-K-29-G-PS-PC-F1	1	GRAPHIC(F1) 23.62 w x 94.50 h Pillowcase Graphic, dye-sub print on 8oz. Power Stretch, single sided, sewn with zipper.
CUS-FABSTR-5	2	600MM X 2400MM, 30MM CUSTOM FABRIC STRUCTURE
HP-K-29-G-PS-PC-H1	1	GRAPHIC(H1) 23.62 w x 94.50 h Pillowcase Graphic, dye-sub print on 8oz. Power Stretch, single sided, sewn with zipper.
CUS-FABSTR-6	2	600MM X 2400MM, 30MM CUSTOM FABRIC STRUCTURE
HP-K-29-G-K1	1	GRAPHIC(K1) 47.13 w X 94.37 h finished size Dye-sub print on 8oz. Power Stretch, with FCE-2 silicone beading sewn to back perimeter, corner pull sewn in bottom right corner
HP-K-29-G-PS-PC-J1	1	GRAPHIC(J1) 23.62 w x 94.50 h Pillowcase Graphic, dye-sub print on 8oz. Power Stretch, single sided, sewn with zipper.
HP-K-29-G-PS-PC-L1	1	GRAPHIC(L1) 23.62 w x 94.50 h Pillowcase Graphic, dye-sub print on 8oz. Power Stretch, single sided, sewn with zipper.

**INSTALL BOTH KIOSK GRAPHICS LAYING DOWN
STAND UP WITH TWO PEOPLE**

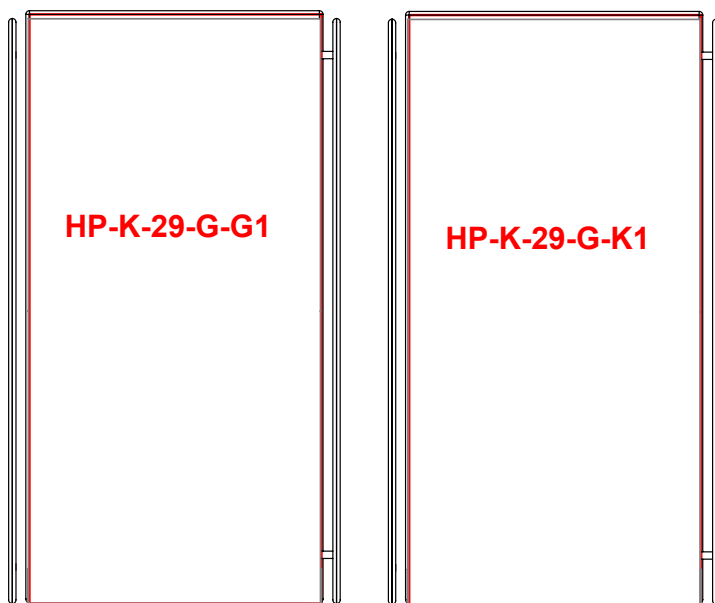

CUS-FABSTR-5 CUS-FABSTR-6

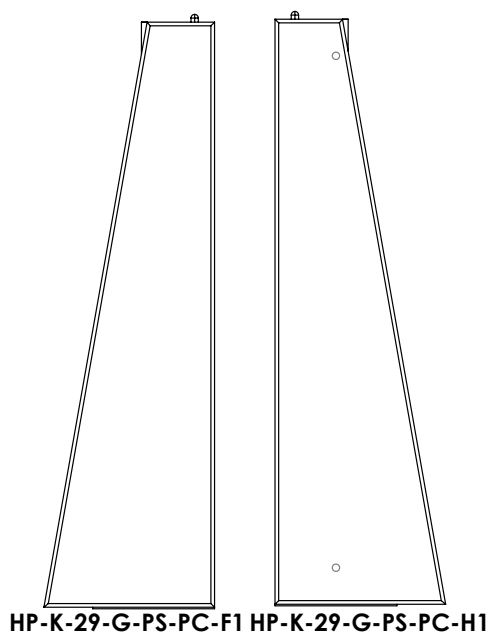

CUS-FABSTR-5

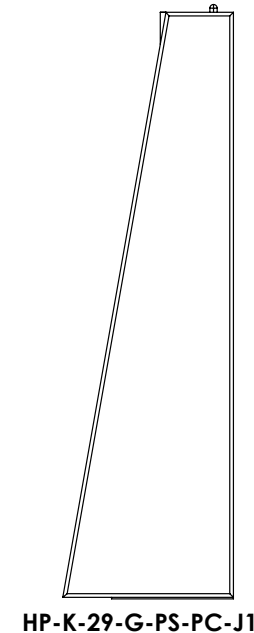

CUS-FABSTR-6

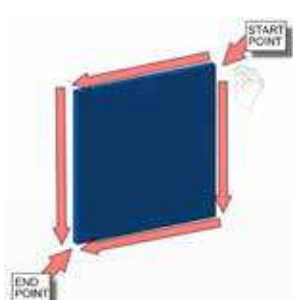
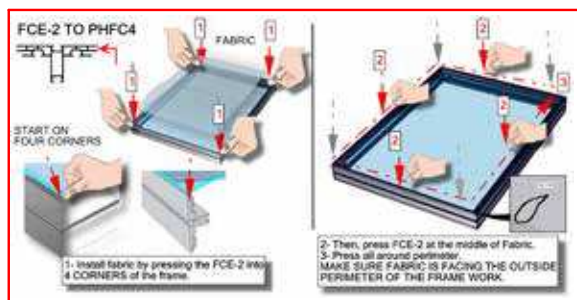
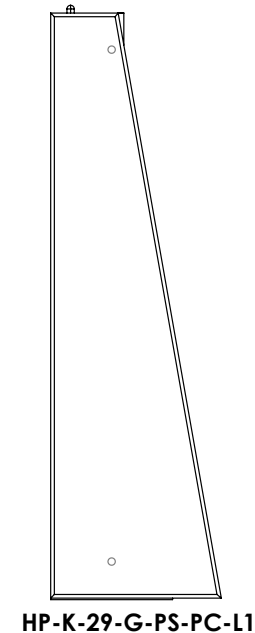

Code	#	Description
CUS-FABSTR-5	2	600MM X 2400MM, 30MM CUSTOM FABRIC STRUCTURE
CUS-FABSTR-6	2	600MM X 2400MM, 30MM CUSTOM FABRIC STRUCTURE

KIOSK FABRIC STRUCTURE

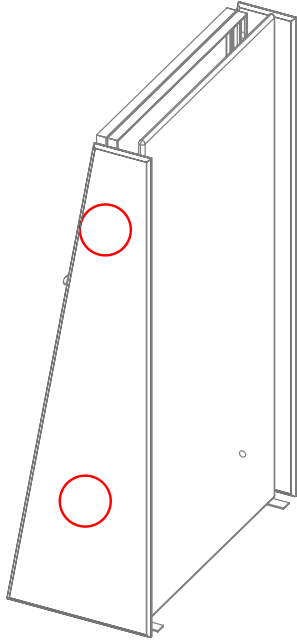

**HAVE ONE PERSON
HOLD THE FABSTR
WHILE ANOTHER
LOCKS IT IN PLACE**

**THEN SLIDE THE BACK
MODFRM 13 IN PLACE**

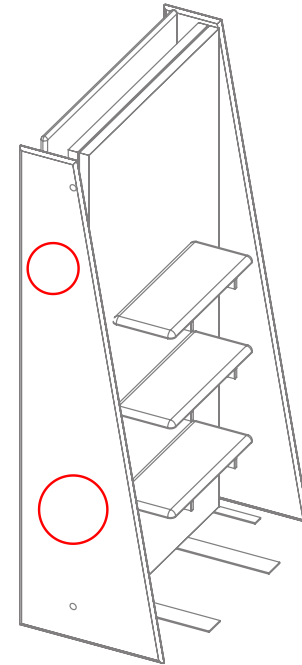

Modulate Frame 13

MOD-FRM-13

Modulate™ Fabric Banners feature unique angles and shapes, are portable and easy to assemble. Choose from multiple frame shapes and connect them to design your own combinations. The aluminum tube frames feature snap-button and spigot connections and are coupled with a printed pillowcase fabric graphic that slips over the frame and zips at the bottom. Two linking clips are included to connect banner frames together and universal feet connect the tube frames at the bottom of the display. Each frame comes in a durable, portable carry bag.



features and benefits:

- Premium aluminum tube frame with spigot and snap button assembly
- Easy to store and ship
- Quick to set up
- Weighted feet for added stability
- Comes with carry bag and box
- Zipper pillowcase fabric graphics
- Lifetime limited hardware warranty against manufacturer defects

dimensions:

Hardware	Graphic
<p>Assembled unit: 48.74" w x 96" h x 17.72" d 1238mm(w) x 2438mm(h) x 450mm(d)</p> <p>Approximate weight: 10 lb / 5 kg</p>	Refer to related graphic template for more information.
Shipping	additional information:
<p>Packing box(es): 1 Box</p> <p>Box size: 48" l x 11" h x 4" d 1219mm(l) x 279mm(h) x 102mm(d)</p> <p>Approximate shipping weight: 12 lb / 6 kg</p>	<p>Graphic material: Dye-sublimation zipper pillowcase fabric</p> <p>When included in a larger kit, a different packaging solution will be listed to accommodate all contents of the kit. Individual packaging no longer provided.</p>

Included In Your Kit

Tools, Components, Connectors, Tubes & Graphics



HEX KEY SET x1



TC-30-T x2



TC-30-90T x2



ES30-90B x2



PLT-BP-LN114-S5-450 x2



LN114-SCRW x2



MOD-FRM-13-T2 x3



MOD-FRM-13-T1 x4



MOD-CLP-180 x2



MOD-FRM-13-G x1

Exploded View

MOD-FRM-13

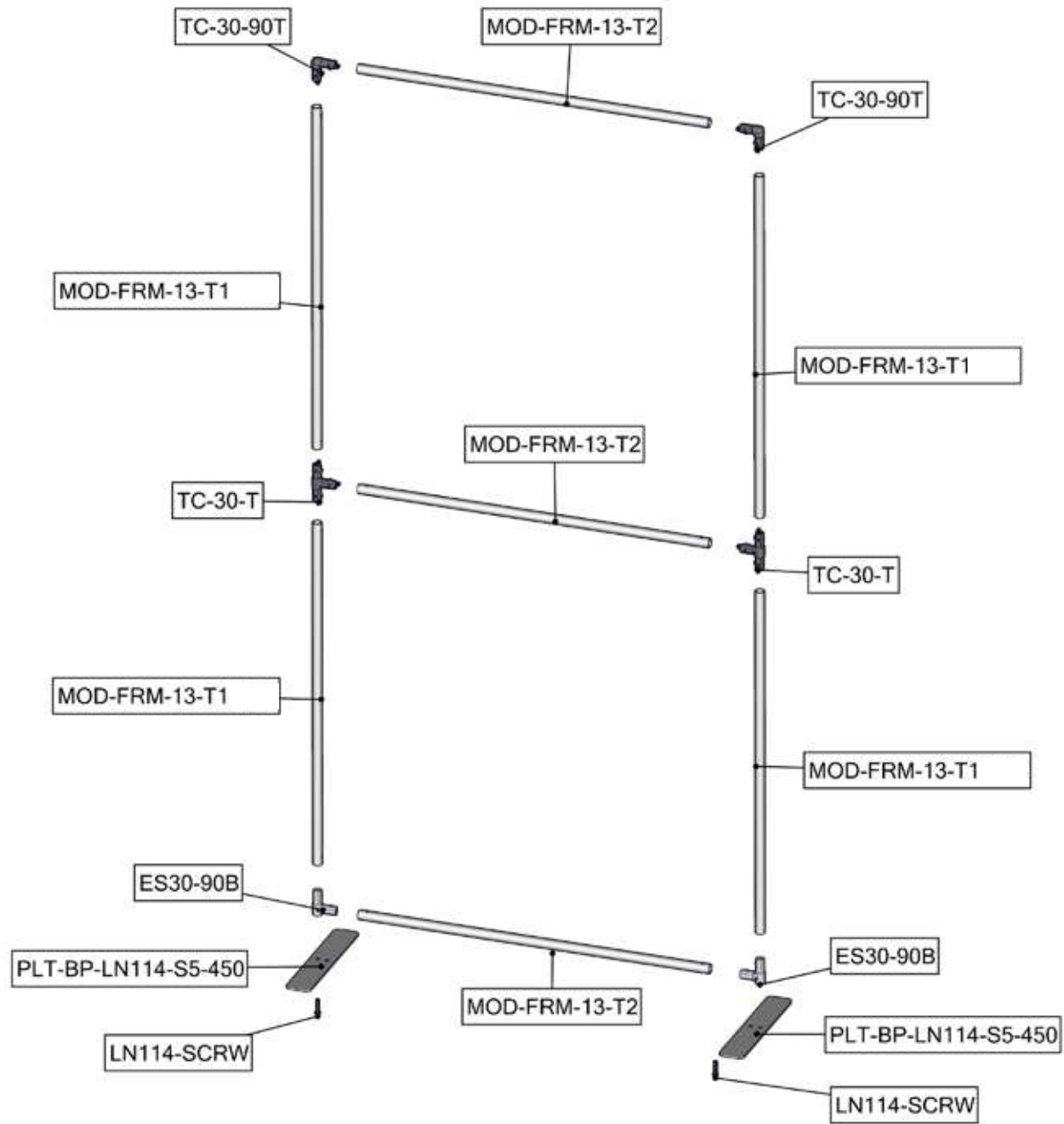

Labeling Diagram

MOD-FRM-13

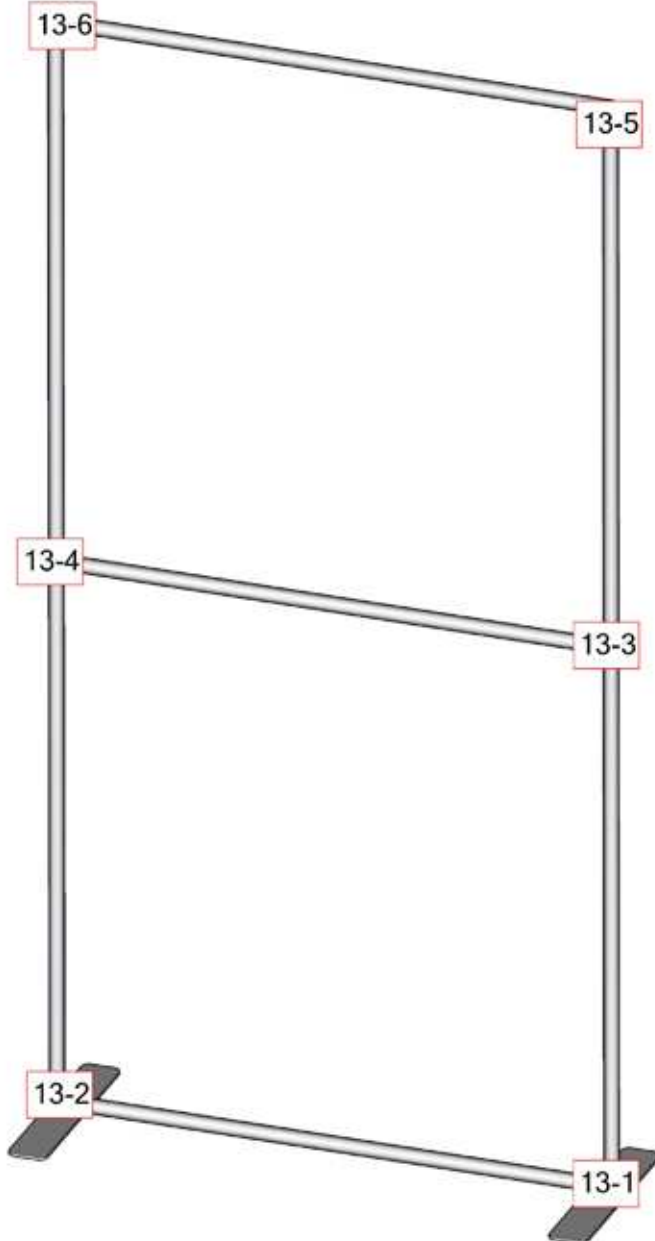

Connection Methods

Connection Method 1: TC-30-T

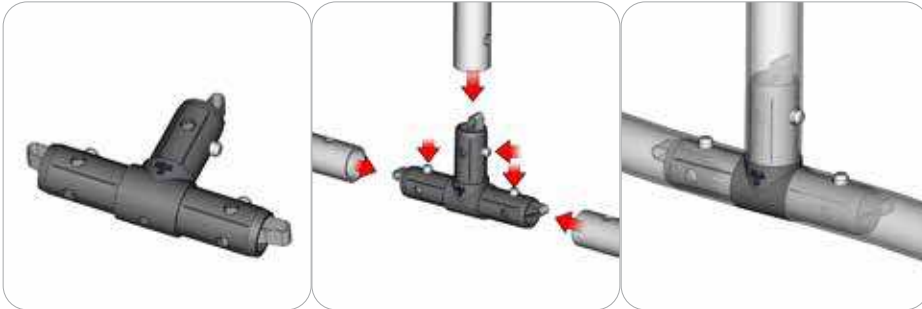

Take the plastic connector and make sure the snap buttons are in proper position for the frame tube holes. Simply press the snap button with your thumb and carefully slide the tube onto the connector. The snap button should pop through. Some twisting may be necessary to assure the snap button has popped all the way through the tube hole. Do not force the connection and be careful with the tube edges, they may be sharp.

Connection Method 2: TC-30-90T

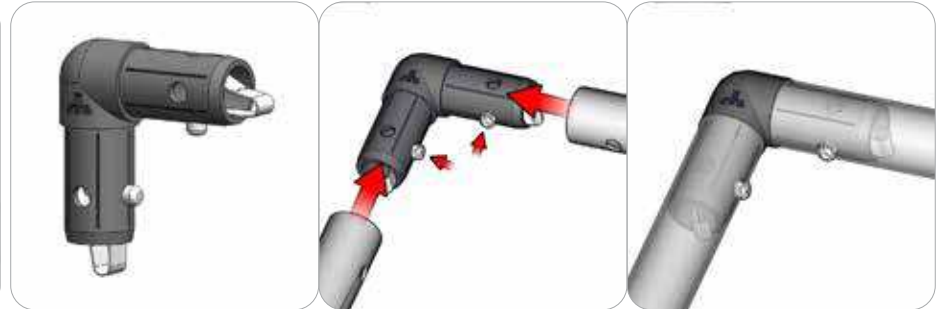

Take the plastic connector and make sure the snap buttons are in proper position for the frame tube holes. Simply press the snap button with your thumb and carefully slide the tube onto the connector. The snap button should pop through. Some twisting may be necessary to assure the snap button has popped all the way through the tube hole. Do not force the connection and be careful with the tube edges, they may be sharp.

Connection Method 3: TC-30-X

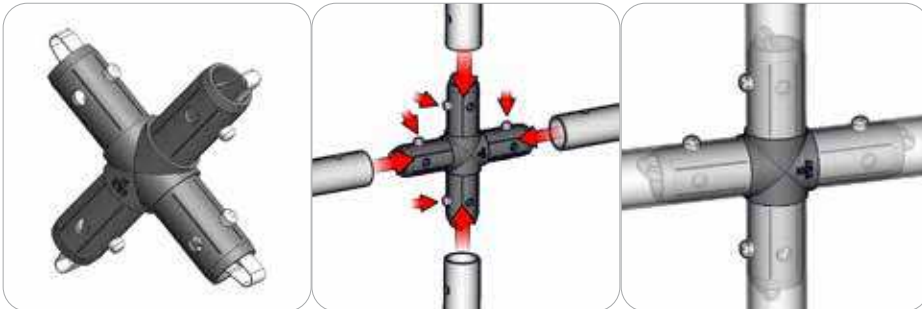

Take the plastic connector and make sure the snap buttons are in proper position for the frame tube holes. Simply press the snap button with your thumb and carefully slide the tube onto the connector. The snap button should pop through. Some twisting may be necessary to assure the snap button has popped all the way through the tube hole. Do not force the connection and be careful with the tube edges, they may be sharp.

Connection Method 4: TC-30-T-CS

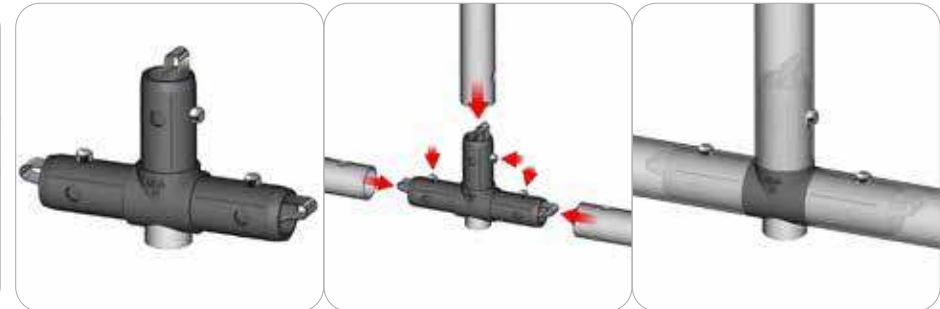

Take the plastic connector and make sure the snap buttons are in proper position for the frame tube holes. Simply press the snap button with your thumb and carefully slide the tube onto the connector. The snap button should pop through. Some twisting may be necessary to assure the snap button has popped all the way through the tube hole. Do not force the connection and be careful with the tube edges, they may be sharp.

Connection Methods

Connection Method 5: ES30-90B



Compress one unlocked end of the connector and slide it through one tube end. Compress the other end of the connector and slide the second tube on. Lock both screws carefully using your allen key tool. Be sure to lock securely, but do not over tighten.

Connection Method 6: PLT-BP-LN114-S5

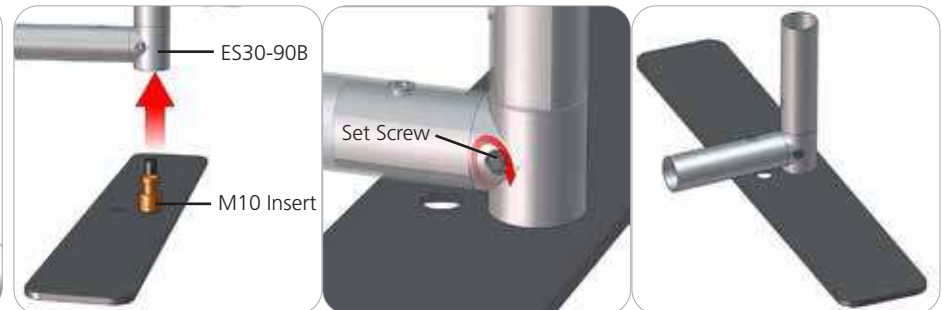

First, loosen the set screw that is on the ES30-90B, then attach the base plate with the M10 insert. Once the base plate is in the desired position, fasten the set screw to hold the insert in place.

Connection Method 7: PLT-BP-LN114-S5



To attach two frames side by side loosen the set screw that is on the ES30-90B. Do not remove the set screw. Next, rotate the stabilizing base hole to the outside of the frame and tighten the set screw. Next, use the provided ES30-90B M10 bolt to fasten the frame onto the base. Don't forget to use your frame clip at the top to level the panels.

Connection Method 8: MOD-CLP

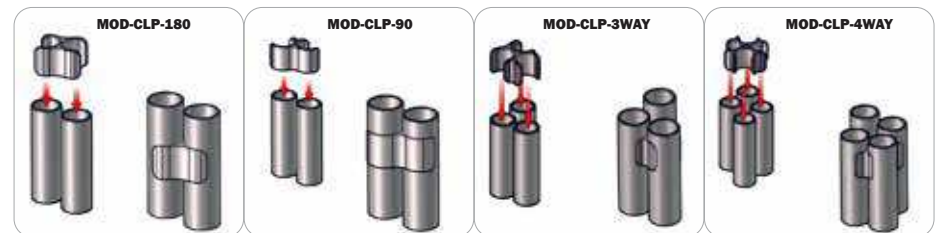

Be sure to fully assemble all frames with fabric pillowcase before using clips. Simply snap the frames into the clips and adjust until frames are aligned as desired.

Kit Assembly

Step by Step

Step 1.

Gather the components to build the frame. Use the Exploded View and the Labeling Diagram for part labels.

Reference Connection Method(s) 1, 2 and 5 for more details.

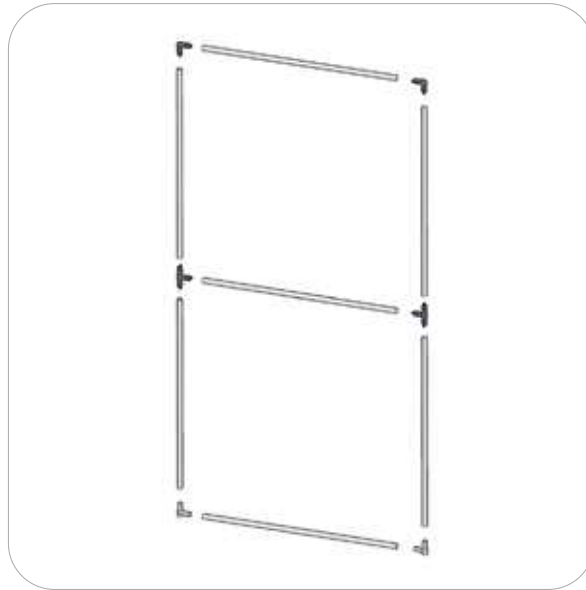

Step 2.

Locate your pillowcase graphic. With the pillowcase unzipped, encase the frame by covering the frame from top to bottom. Zipper at the bottom.

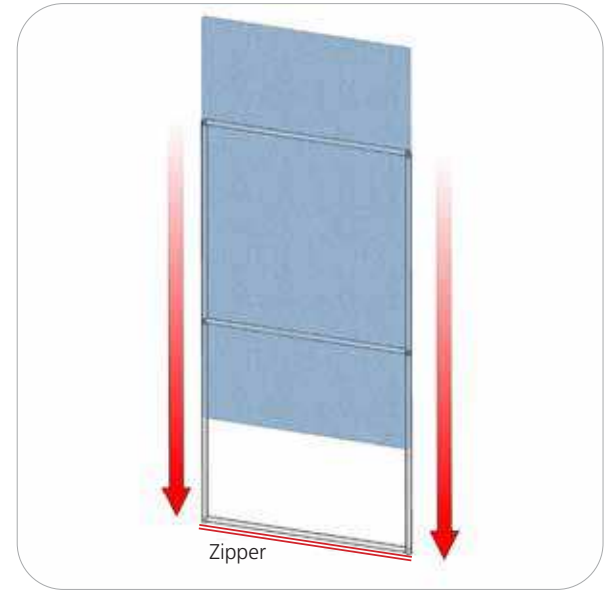

Step 3.

Locate the stabilizing bases. Attach each foot to the bottom ends of the frame. Use the allen key tool provided to lock the bases in place.

Reference Connection Method(s) 6 for more details.



Step 4.

Setup is complete.

If you are connecting frames side by side, reference Connection Method(s) 7 and 8 for more details.



Code	#	Description
A13	4	PHFC4-1200 EXTRUSION-WITH IB2 LOCK HOLE-WITH MITRE CUT FOR CB9
CB9	4	90 DEGREE JOINER
A8	4	PHFC4-1200 EXTRUSION-WITH IB2 LOCK HOLE-WITH MITRE CUT FOR CB9-SIDE
IB2	5	JOINER BAR(NEW DESIGN)
A12	1	1155MM PH1 EXTRUSION-WITH IB2 LOCK HOLE-CAM LOCK
A12	1	1155MM PH1 EXTRUSION-CAM LOCK-WITH IB2 LOCK HOLE



VECTOR FRAME BACKWALL X 2

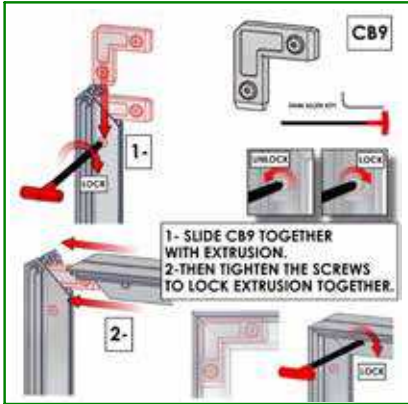
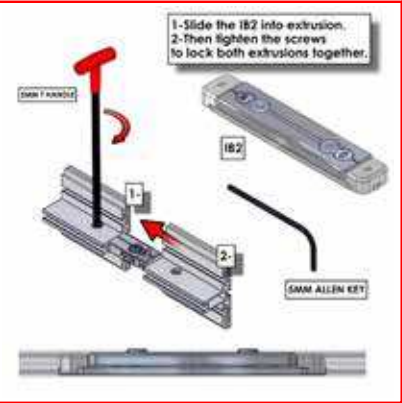

ASSEMBLE FARME LAYING DOWN

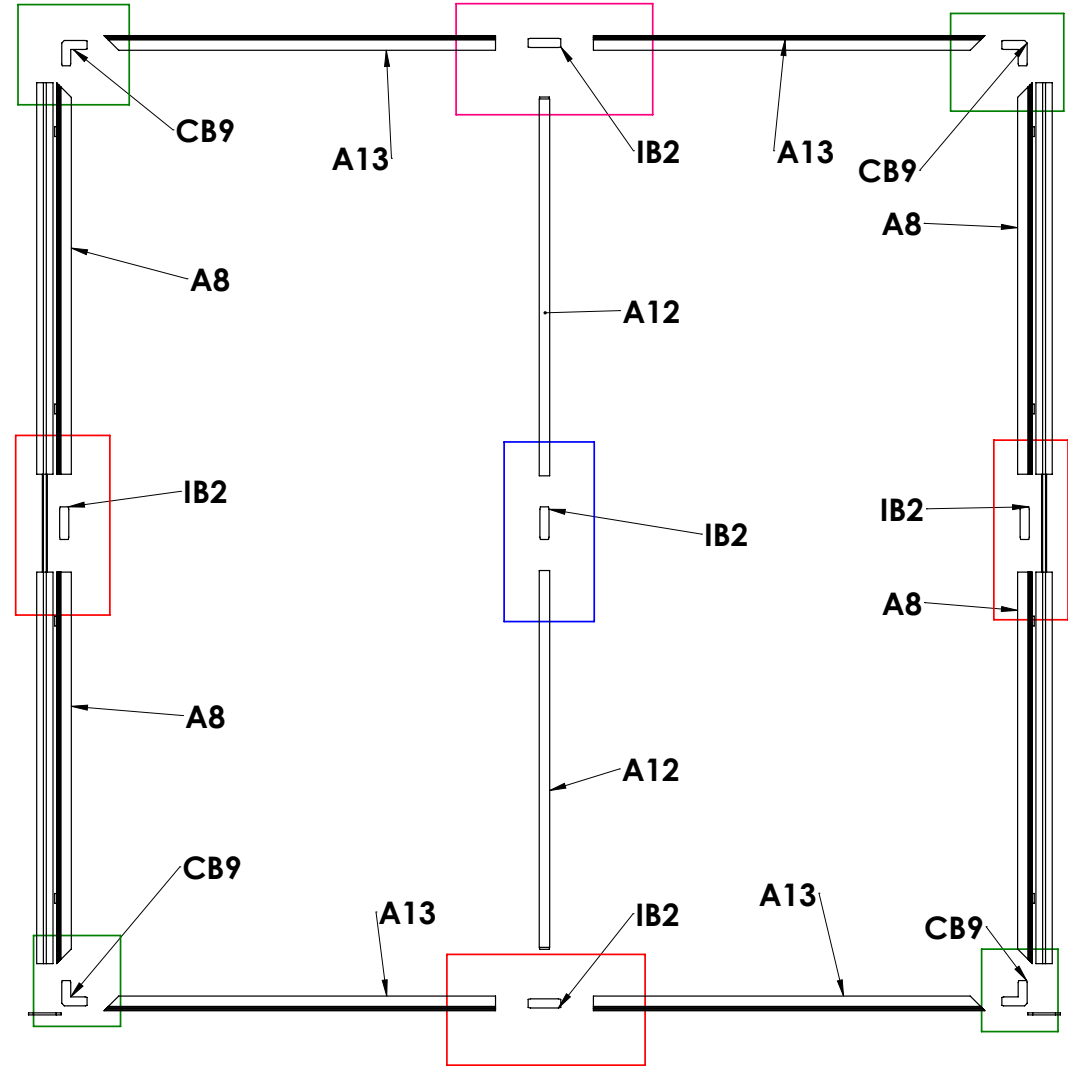

MAKE SURE PH1 COLUMN IS INPLACE BEFORE THE TOP IS ATTACHED

Code	#	Description
LN114-S2-650	2	FOOT PLATE , 650MM LENGTH
A10	2	600MM PH2-TG EXTRUSION
A11	2	1200MM PM4S3-1200 EXTRUSION-WITH STOP AT 315MM-WITH STOP AT 315MM
A9	2	1200MM PM4S3-1200 EXTRUSION-WITH STOP AT 315MM-WITH NUT INSERT

VECTOR FRAME BACKWALL LEGS SUPPORTS X 2

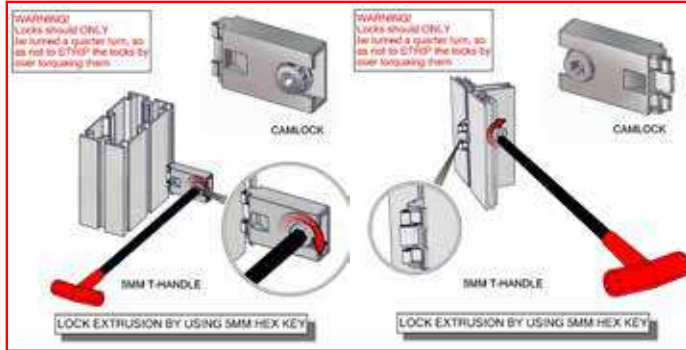

ASSEMBLE FERME
LAYING DOWN

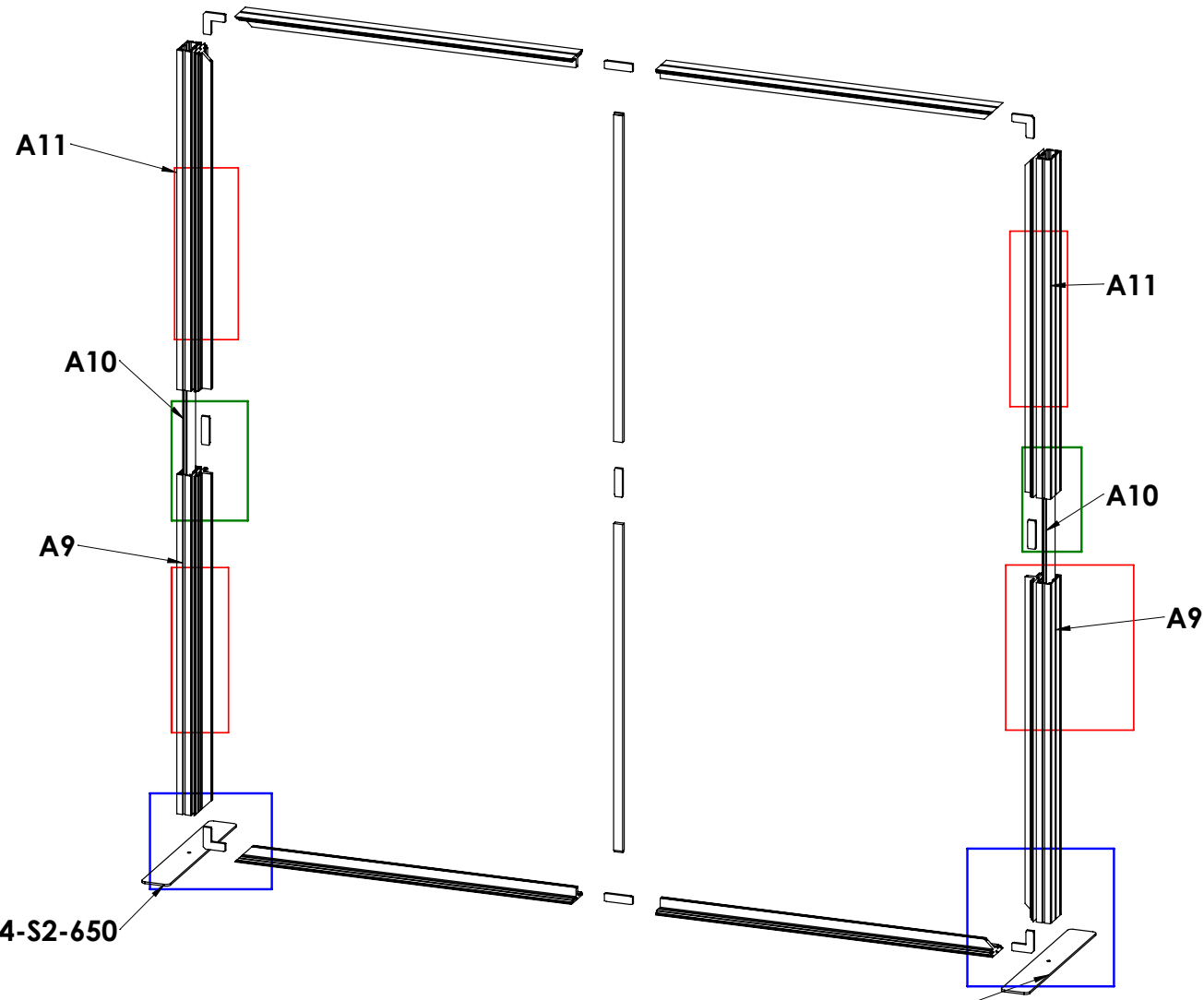

LN114-S2-650

Code	#	Description
HP-K-29-G-A1	1	GRAPHIC(A1) 94.37 w X 94.37 h finished size Dye-sub print on 8oz. Power Stretch, with FCE-2 silicone beading sewn to back perimeter, corner pull sewn in bottom right corner
HP-K-29-LN-A2	1	LINER(A2) 94.37 w X 94.37 h finished size Opaque liner, with FCE-2 silicone beading sewn to back perimeter, corner pull sewn in bottom right corner

BACKWALL GRAPHICS 1

**HAVE THE FRAME LAYING DOWN WHILE INSTALLING THE GRAPHIC
STAND UP FOR THE LINER**

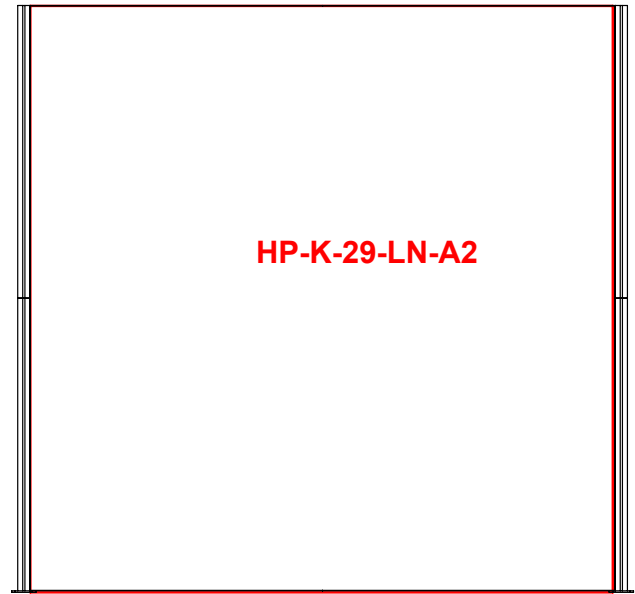
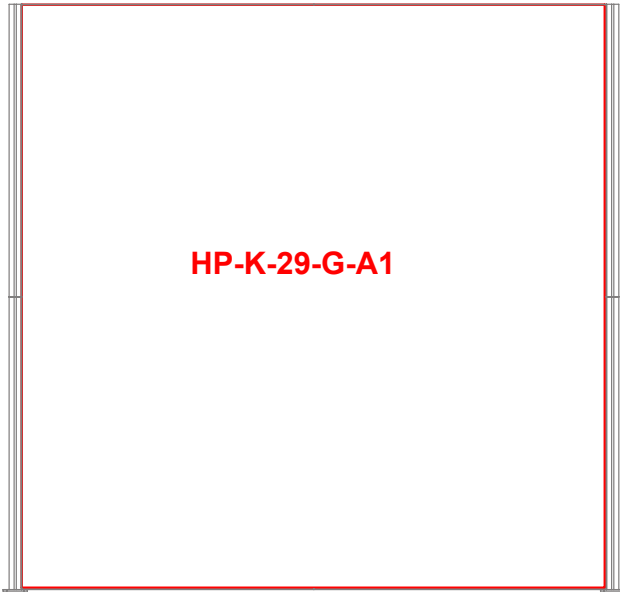

HAVE TWO PEOPLE STAND IT UP AFTER GRAPHICS ARE INSTALLED

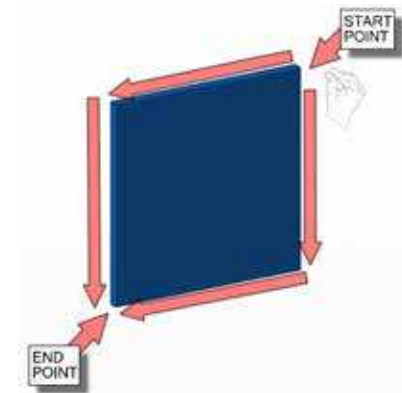
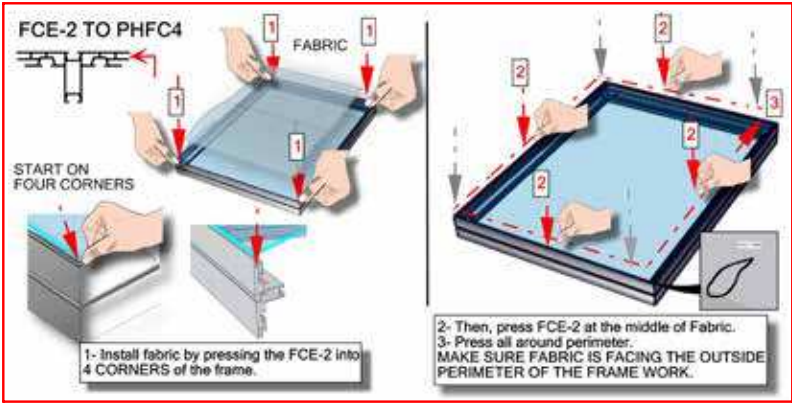

Code	#	Description
HP-K-29-LN-D2	1	LINER(D2) 94.37 w X 94.37 h finished size Opaque liner, with FCE-2 silicone beading sewn to back perimeter, corner pull sewn in bottom right corner
HP-K-29-G-D1	1	GRAPHIC(D1) 94.37 w X 94.37 h finished size Dye-sub print on 8oz. Power Stretch, with FCE-2 silicone beading sewn to back perimeter, corner pull sewn in bottom right corner

BACKWALL GRAPHICS 2

**HAVE THE FRAME LAYING DOWN WHILE INSTALLING THE GRAPHIC
STAND UP FOR THE LINER**

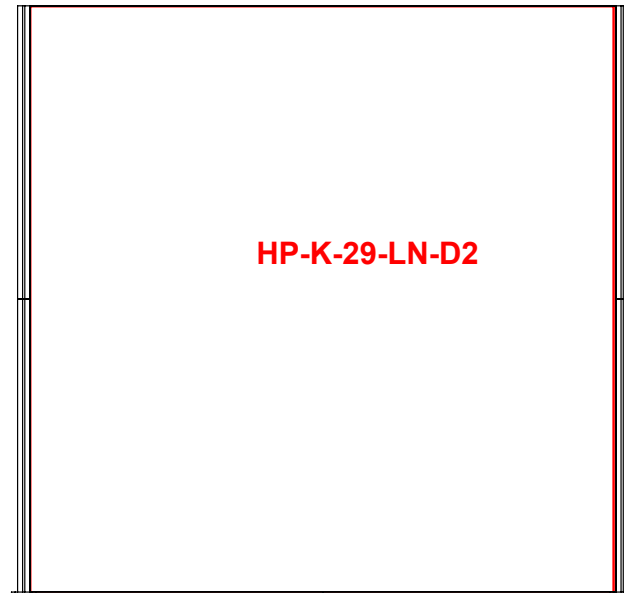
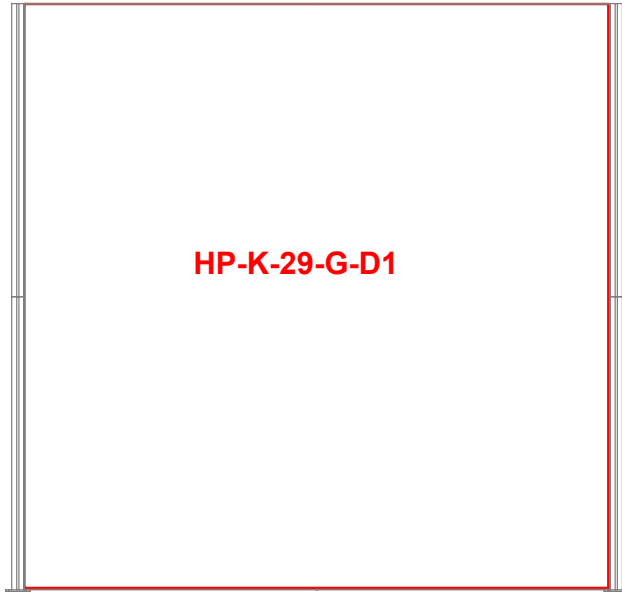

HAVE TWO PEOPLE STAND IT UP AFTER GRAPHICS ARE INSTALLED

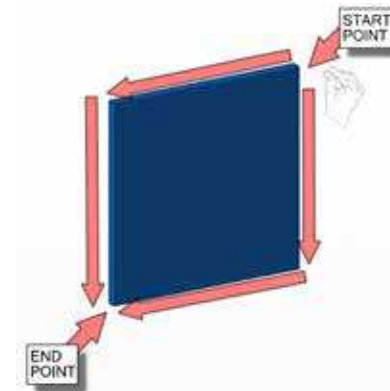
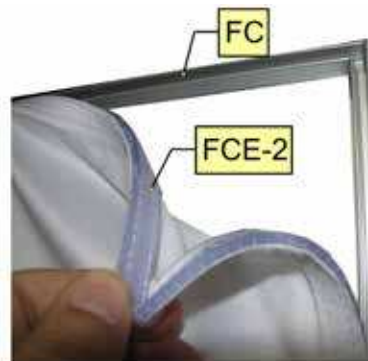
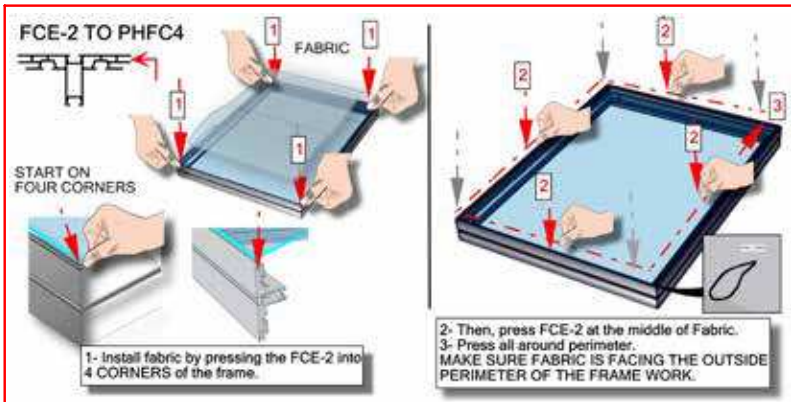

Code	#	Description
CUST-PLT-WP-PM4-30	4	PM4S3 MOUNTING PLATE 3.937" X 1.96" X .188"
TC-50MM-SILVER	4	SILVER ANODIZED FINISH 50MM TUBE CLAMP
A10	4	600MM PH2-TG EXTRUSION
A14	4	600MM PM4S3-600 EXTRUSION

SUPPORT FOR OVAL FABRIC STRUCTURE

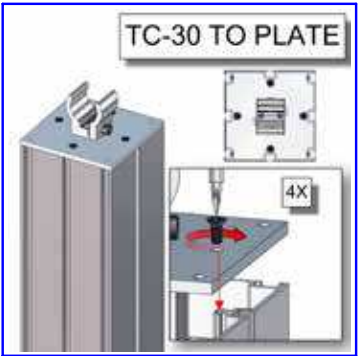
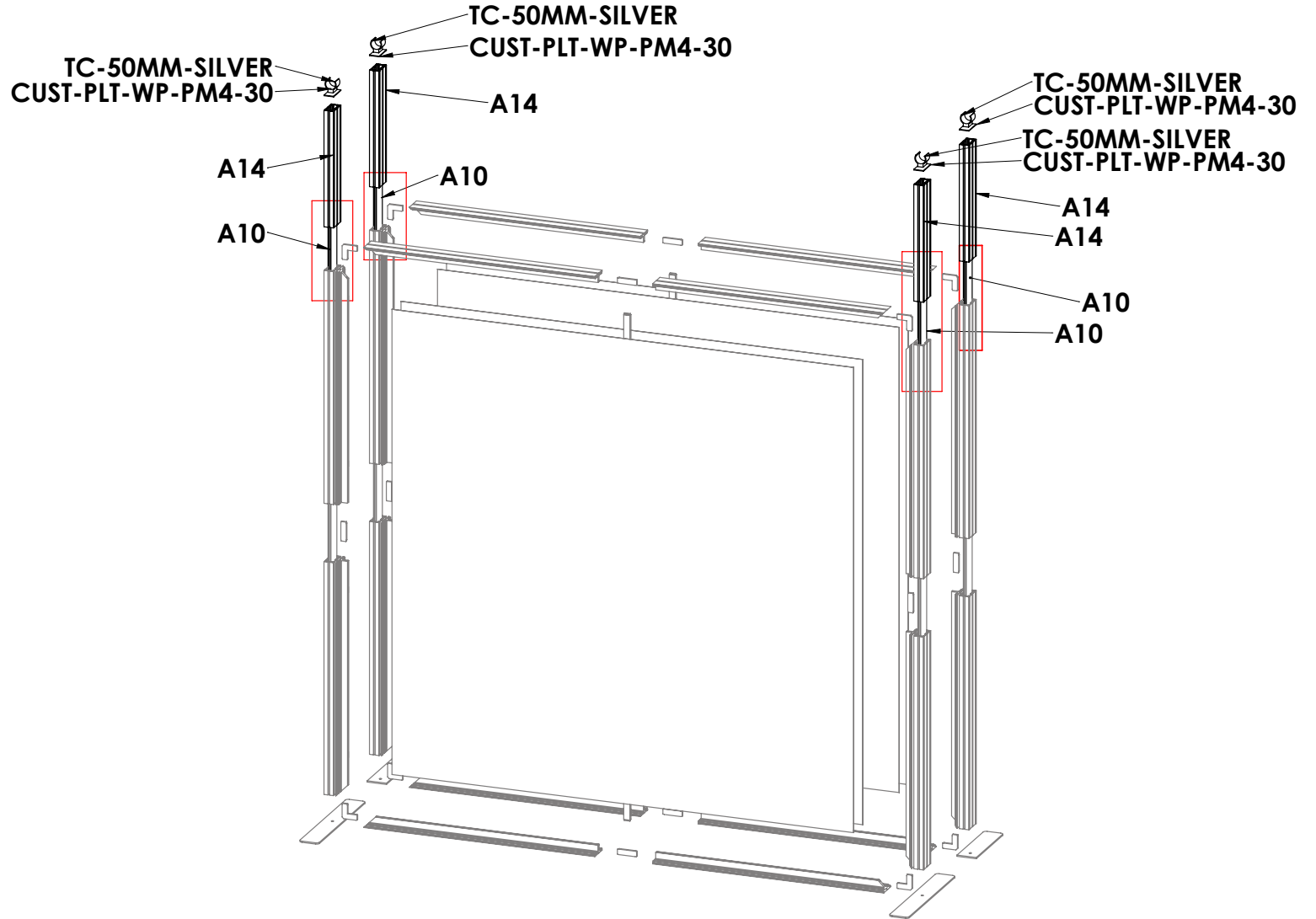

**ATTACH TO PM4S3
BEFORE PUTTING
PM4S3 IN PLACE**

SET UP INSTRUCTIONS:

1. CONNECT BOTTOM AND TOP TUBES FOLLOWING THE LABELS
2. CONNECT SIDE TUBES
3. CLEAN THE FRAME AND PLACE THEM ON CLEAN PLACE
4. CAREFULLY REMOVE FABRIC COVER FROM BAG
5. PLACE COVER AROUND THE BOTTOM OF THE FRAME
6. PULL COVER CAREFULLY UP TO THE TOP
7. CLOSE ALL ZIPPERS
8. ADJUST FABRIC AROUND THE FRAME
9. CONNECT CABLE HARNESS TO THE EYEBOLTS
10. COMPLETELY TIGHTEN THREADED CONNECTORS

BREAK DOWN INSTRUCTIONS:

REVERSE SET-UP STEPS TO BREAKDOWN FRAME

FABRIC CARE INSTRUCTIONS:

1. UNZIP COVER ZIPPERS
2. CAREFULLY REMOVE FABRIC COVER
3. CLOSE ALL ZIPPERS
4. FOLD OR ROLL NEATLY
5. PLACE FABRIC IN COVER BAG

LABELING DIAGRAM FOR HP-K-29-SQU

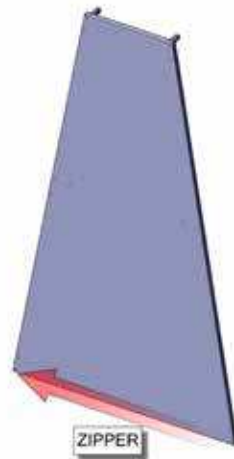
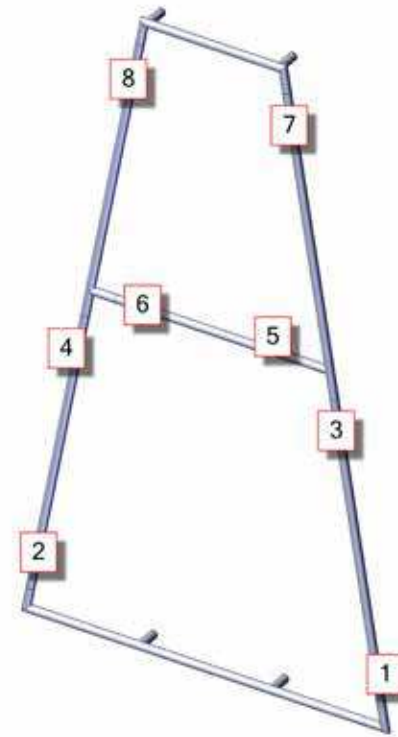

PARTS DIAGRAM

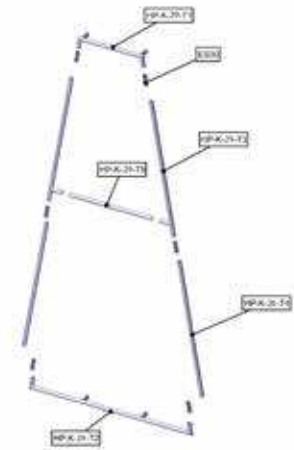

Code	#	Description
CUS-FABSTR-3	1	600MM X 2400MM, 30MM CUSTOM FABRIC STRUCTURE
HP-K-29-PS-PC-G-C1	1	GRAPHIC(C1) 23.62 w x 94.50 h Pillowcase Graphic, dye-sub print on 8oz. Power Stretch, single sided, sewn with zipper.
CUS-FABSTR-4	1	1400MM X 2400MM, 30MM CUSTOM FABRIC STRUCTURE
HP-K-29-PS-PC-G-E1	1	GRAPHIC(E1) 55.11 w x 94.50 h Pillowcase Graphic, dye-sub print on 8oz. Power Stretch, single sided, sewn with zipper.
HP-K-29-PS-PC-G-B1	1	GRAPHIC(B1) 23.62 w x 94.50 h Pillowcase Graphic, dye-sub print on 8oz. Power Stretch, single sided, sewn with zipper.
CUS-FABSTR-2	1	600MM X 2400MM, 30MM CUSTOM FABRIC STRUCTURE

PILLOW CASE GRAPHICS



AFTER ASSEMBLING THE FABSTR FRAME SLIDE THE GRAPHICS COVER OVER THE FRAME AND ZIP CLOSED

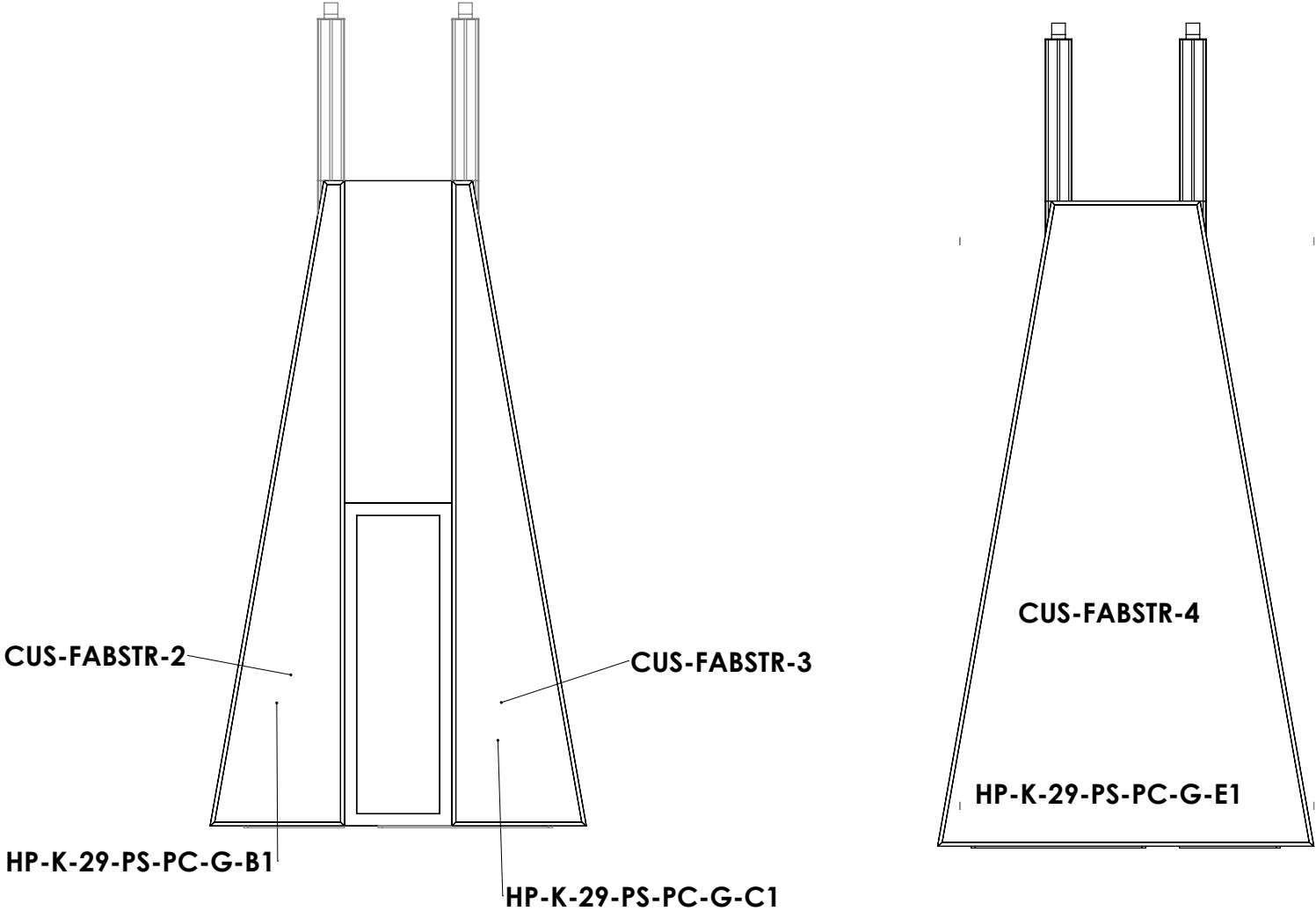

Code	#	Description
CUS-LP-400-1200-L0S	1	400MM X 1200MM LOCK PANEL (Color TBD)
CUS-FABSTR-3	1	600MM X 2400MM, 30MM CUSTOM FABRIC STRUCTURE
CUS-LP-CD-400-1200	1	400MM(W) X 1200MM(V) CUSTOM LOCK CABINET DOOR PANEL (COLOR TBD)
CUS-FABSTR-4	1	1400MM X 2400MM, 30MM CUSTOM FABRIC STRUCTURE
CUS-FABSTR-2	1	600MM X 2400MM, 30MM CUSTOM FABRIC STRUCTURE

HAVE 3 PEOPLE HELP TO INSTALL THE FABRIC STRUCTURE TWO TO HOLD AND ONE TO LOCK IN PLACE

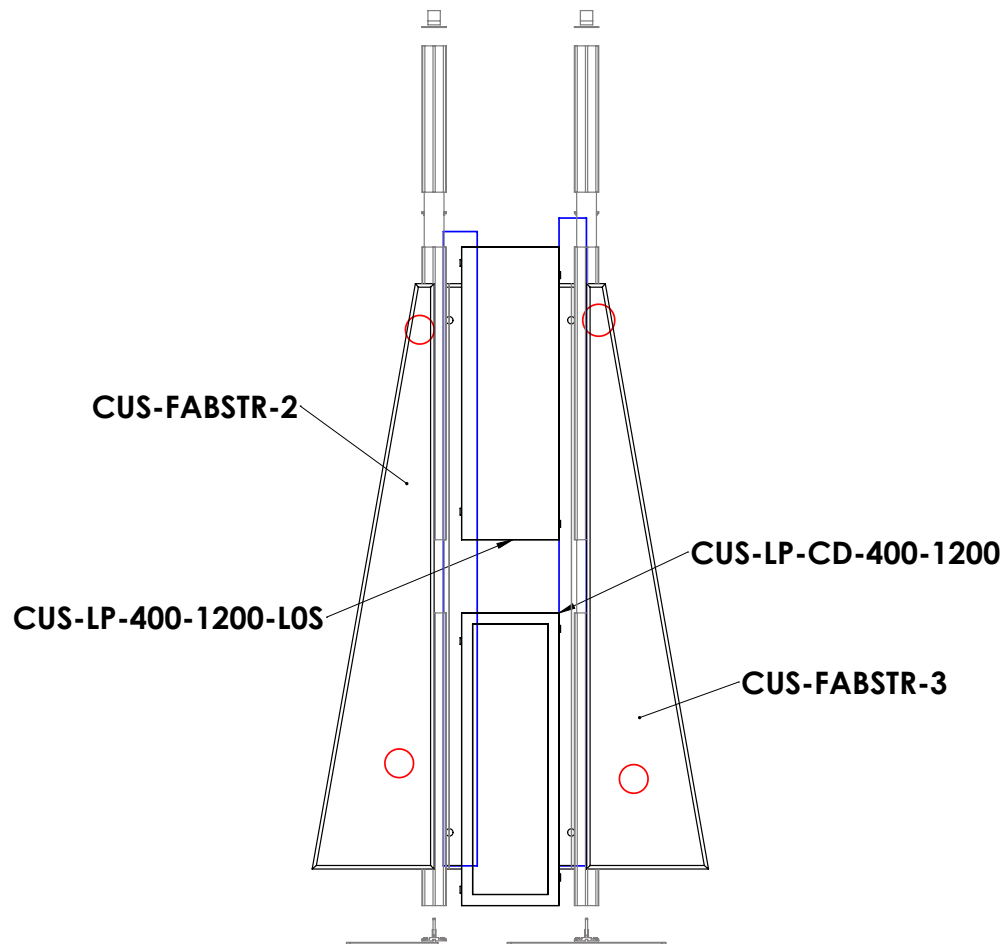
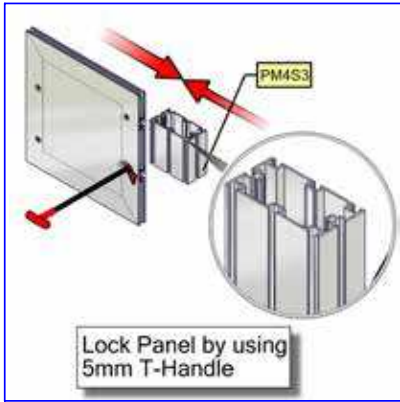

STORAGE DOOR AND FABRIC STRUCTURE

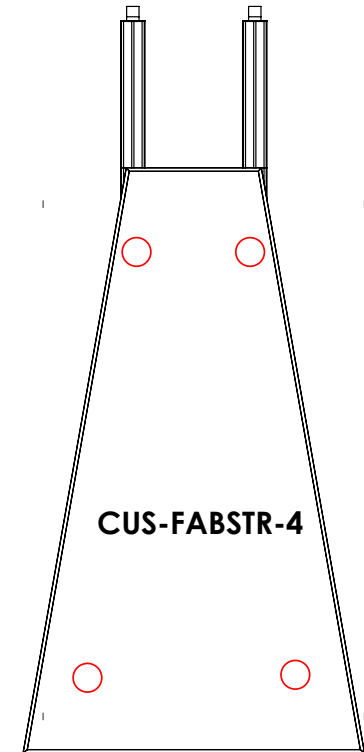

Code	#	Description
CUS-G-PS-PC-G	1	GRAPHIC(P1) Pill shape graphic, dye-sub print on 8oz. Power Stretch, single sided, sewn with zipper
CUS-FABSTR-1	1	13' X 4' X 3' PILL-SHAPED FABRIC STRUCTURE

OVAL SHAPED FABRIC STRUCTURE AND GRAPHICS

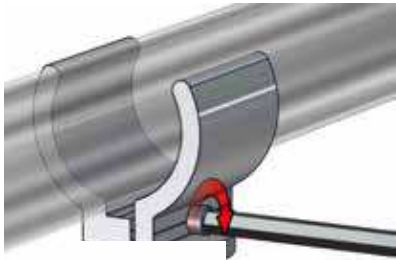

PUT THE GRAPHIC ON BEFORE PUTTING THE FRAME INPLACE



HAVE THREE OR MORE PEOPLE HELP WITH LIFTING FRAME INPLACE

