

Deluxe Geo Connecting Kit

Item #	FRAMES	FACE PLATES	CONNECTING PLATES	STRAIGHT SHELF	CONNECTING SHELF	REPLACEMENT GRAPHIC KIT	FABRIC GRAPHICS
342022	3 Qd x2	0	32	4	2	342024	(2) H (2) M
342025	3 & 9 Qd	16	32	8	2	342027	(1) J (2) M, 9 Qd Backwall
342028	6 Qd x2	16	32	4	2	342030	(2) F (2) G (2) M (2) E
342031	3 (x2) & 6 Qd	8	48	8	4	342033	(2) B (2) A (2) H (2) M (2) B
342034	3 Qd x4	0	64	8	4	342036	(12) A (24) K
342037	6 Qd x2	28	24	2	8	342039	(2) H (2) K (2) C (2) E
342040	3 Qd x3	0	48	4	4	342042	(2) H (2) J (6) M

Product Parts for HARDWARE

- 1 - Geometrix Face Plates**
- 2 - Geometrix Connecting Face Plates**
- 3 - Soft Case
- 4 - Frame
- 5 - Clear Shelf
- 6 - Clear Connecting Shelf
- 7 - Fabric Graphic

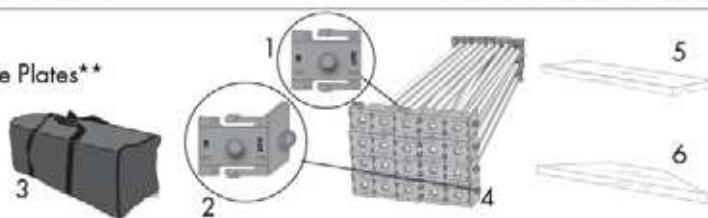

**Frames (4) should come with Face/Connecting Plates installed.

Product Parts for FABRIC GRAPHIC (skip to STEP 4)

7 - Fabric Graphics (qty varies) see page 3 & 4 for layout of graphics.



Display Set-Up

Step 1

Remove all parts from your Soft Carry Case and boxes (3) and place on a flat, clean surface. Review the Frame (4) and notice where the pivoting light clips are located. This will determine the TOP of the display.

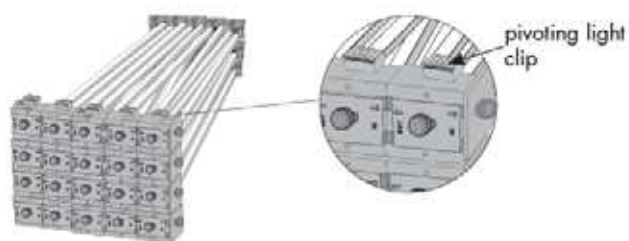

Step 2

Pull the Frame (4) up and out from the corners until it is fully expanded.

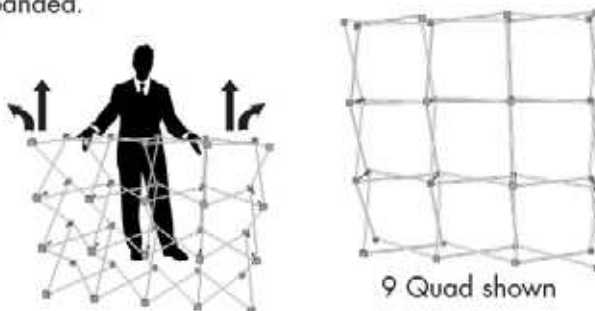

Step 3

Push all locking clips together to secure the Frame (4) in its expanded position.



OPEN



CLOSED



Pressure may need to be applied to secure.

Step 4

Attach Fabric Graphics (7) to frame by locating hole slits in each corner and securing them around the plastic pin on the face or corner plate. Repeat this step for each banner until all are secured to frame in pre-set locations (see pages 3 and 4).



Step 5

Place the shelf (5) within the Frame (4) making sure all four notches on the shelf sides fit over the Frame (4) "scissors". Push gently down until level.

Connecting Shelves (6) rest on the Connecting Face Plates (2) on outside of Frame

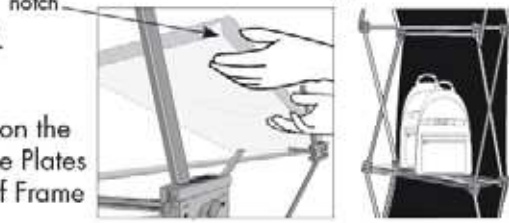

Frame Note:

TO REMOVE/REPLACE FACE PLATES:

If you need to replace or remove existing face or corner plates, find the end of the Plate that is marked "OUT". **see NOTE if you cannot indicate which end is "OUT". Push Face Plate toward the "OUT" arrow.

You may need to tap end with force to get it to start sliding.

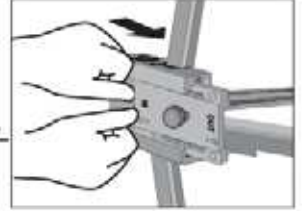

Frame Note:

** REMOVAL NOTE:

Graphic Face Plates (1) have arrows and the words "IN" and "OUT" stamped on them.

To Determine which end is "OUT", look at the end of the Face Plate. The "OUT" side has 2 bump outs. The "IN" side does not.

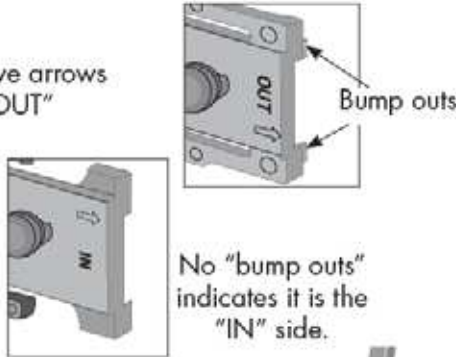

TO INSERT FACE PLATES:

Slide (with force) the Face or corner Plates (1/2) into the hubs. Typically you will slide RIGHT to LEFT when looking at the face of the Frame.



Disassembly Note:

For quick take down and future set up, you may leave graphic banners on Frame (4).

Unlock and **OPEN** all locking clips as shown in Step 3.

REMOVE ANY SHELVES Collapse Frame (4) with all Fabric Graphics (7) attached by pushing down and in on unit.

MAKE SURE ALL LOCKING CLIPS ARE IN OPEN POSITION before collapsing Frame (4)



OPEN



Kit 342022 ↓

Hardware 342023, Replacement Graphic 342024

- x2 - 3 Quad Frame
- x2 - Clear Connecting Shelf
- x4 - Straight Clear Shelf
- x2 - H - Banner
- x2 - M - Banner

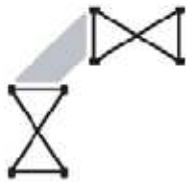

(Top View)

