

## ASSEMBLY HARDWARE

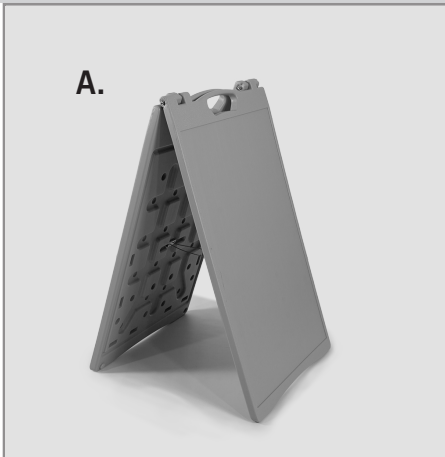

A. PVC Frame with Cable



## ASSEMBLY

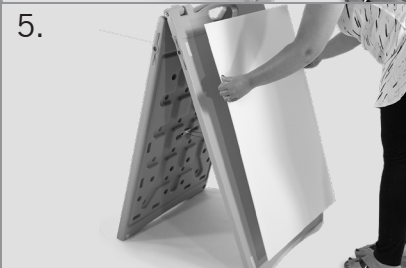
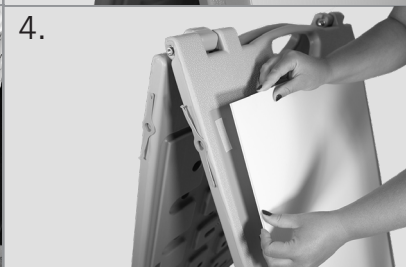

1. Open the PVC Frame until the cable is taut.
2. Locate the hook and loop on both the hardware and the print.
3. Carefully line up your print with the hardware.
4. Gently press the loop on the back of the print to the hook on the hardware.
5. Now your PVC Frame is ready for use.

## FILLING THE FRAME



1. Locate the plug on the side of the frame.
2. Pull the plug out to fill with water or sand. It is easiest to fill with a funnel. (We recommend using sand during colder seasons.)
3. Replace the plug once the PVC frame is filled.

**DISCLAIMER:** Do not set up this product in wind gusts exceeding 25-30mph and/or thunderstorms. User must read and observe assembly instructions. If this is not done correctly it may result in damage to the unit, injury, or death, and all warranties will be void. All warranties will be void if this product is used with any print or hardware not produced by us. This product is not designed to withstand freezing temperatures. Allowing ice to form in or on this product can cause leakage. If product was damaged by ice, it won't be subject to return or replacement. Fill with windshield washer fluid with freeze protection when freezing temperatures are expected/occur.

