

Wind Sail Premium Crescent Construction Sheet

R1.101112

ASSEMBLY HARDWARE

LARGE

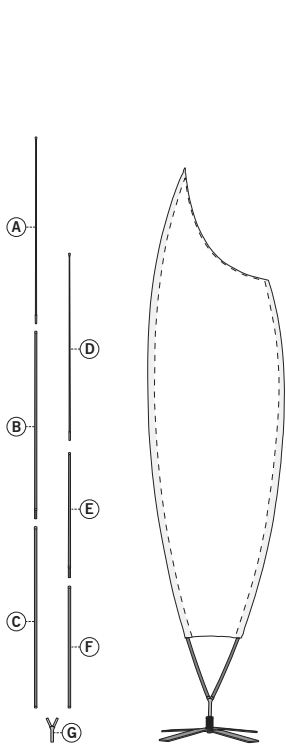

XLARGE

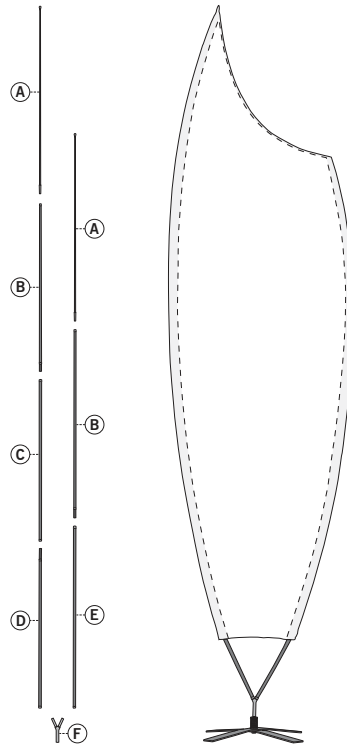

Large:

- A. L3/XL4 – Tip
- B. L2/XL3 – No Interior Sleeve w/ Exterior Insert
- C. L1 – Interior Sleeve w/ No Exterior Insert
- D. M3 – Tip
- E. M2 – No Interior Sleeve w/ Exterior Insert
- F. M1 – Interior Sleeve w/ No Exterior Insert
- G. Y-Connector 50°

XLarge:

- A. (2) L3/XL4 – Tip
- B. (2) L2/XL3 – No Interior Sleeve w/ Exterior Insert
- C. XL2 – No Interior Sleeve w/ No Exterior Insert
- D. XL1 – Interior Sleeve w/ Exterior Insert
- E. L1 – Interior Sleeve w/ No Exterior Insert
- F. Y-Connector 50°



Exterior Insert

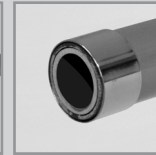

Interior Sleeve

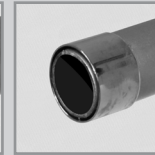

None



Tip

ASSEMBLY

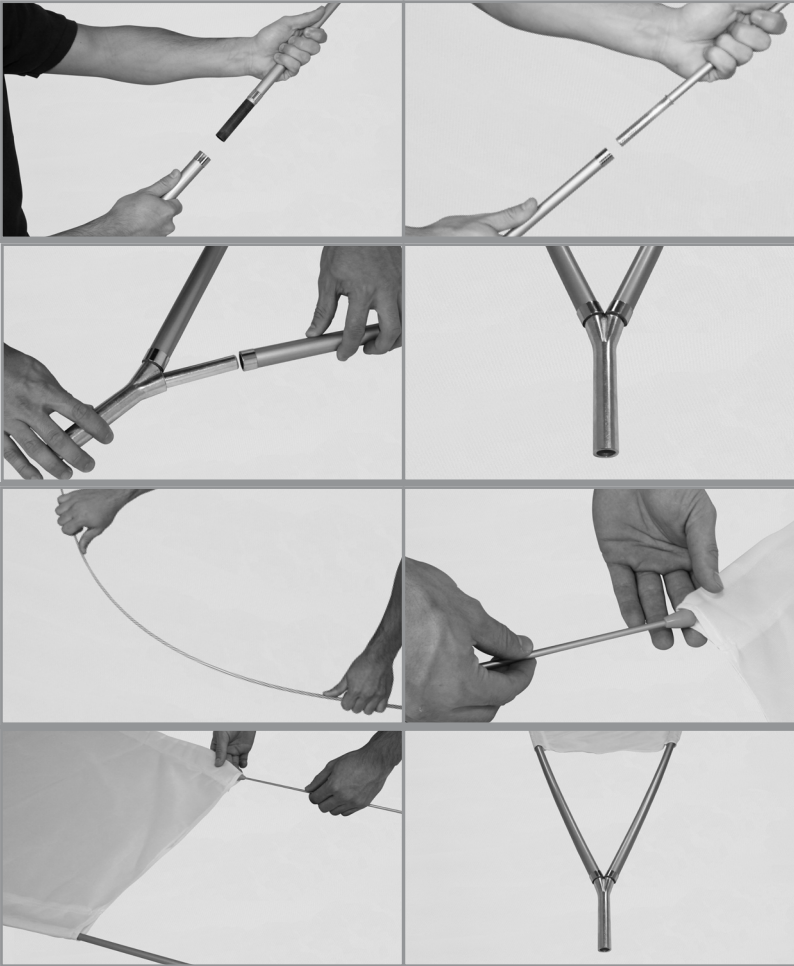

1. Assemble the two sets of poles, one for each pole sleeve. The poles are listed from **top to bottom** and are illustrated in the sketch above.

Large - Left pole sleeve: **L3/XL4** (A), **L2/XL3** (B), **L1** (C)
Right pole sleeve: **M3** (D), **M2** (E), **M1** (F)

XLarge - Left pole sleeve: **L3/XL4** (A), **L2/XL3** (B), **XL2** (C), **XL1** (D)
Right pole sleeve: **L3/XL4** (A), **L2/XL3** (B), **L1** (E)

2. Attach the bottom ends of each set of poles to the **Y-Connector 50°** (G/F).

3. The pole tips are made to flex a little to give the print its shape. Insert the pole tip of the longest set of poles into the left pole sleeve first. Slightly curve the poles towards the second set of poles. Insert the pole tip of the second set of poles into the right pole sleeve.

5. Slide the print down both sets of poles until taut. Be sure that both pole tips are fully inserted into each pole sleeve.

6. Mount the display using one of the available bases.



Do not fly this product in wind gusts exceeding what is listed below and/or thunderstorms. Use with Single-reverse flag: up to 30mph. Use with Double-sided flag: up to 17mph. Do not use near overhead wires and allow a 4' – 12' radius from base for flag clearance depending on size. User must read and observe construction sheet. If this is not done correctly it may result in damage to the unit, injury, or death, and all warranties will be void. All warranties will be void if this product is used with any flag not produced by us.

