

Formulate 10' Horizontal Curve - Kit 5

FMLT-WH10-05

Formulate™ is a collection of sophisticated, ergonomically designed exhibit booths. Formulate combines state-of-the-art zipper pillowcase dye-sublimated fabric coverings with advanced lightweight aluminum structures to provide unique design, functionality, and style. The excellence of the Formulate line of displays, hanging structures and products is simply unmatched. Stretch fabric graphics are hand-sewn, durable and dry-cleanable.



We are continually improving and modifying our product range and reserve the right to vary the specifications without prior notice. All dimensions and weights quoted are approximate and we accept no responsibility for variance. E&OE. See Graphic Templates for graphic bleed specifications.

features and benefits:

- State-of-the-art 30mm aluminum tube frame with snap button assembly
- Easy to store and ship
- Quick to set up
- Kit includes: one frame, one dye-sublimated pillowcase zipper graphic, stand-off counter, and one wheeled molded OCL and OCH2 storage case
- Lifetime hardware warranty against manufacturer defects

dimensions:

Hardware	Graphic
Assembled unit: 112"w x 92.76"h x 32.6"d	Total visual area: 123.125"w x 92"h
Stand-off counter: 23.6"w x 92.7"h x 21.2"d	Stand-off graphic total visual area: Top: 21"w x 17.5"h Bottom: 21"w x 38.7"h
Approximate weight (includes graphic): 46.5 lbs / 21 kg	Please be sure to include a 2" bleed around the perimeter.
Shipping	Refer to related graphic template for more information.
Shipping dimensions - ships in two cases: One OCL case: 19"l x 19"w x 56"h One OCH2 case: 52"l x 30"w x 15"h	
Approximate shipping weight (with cases): 96.5 lbs / 43.7 kg	

additional information:

Graphic materials:
Dye-sublimated zipper pillowcase fabric,
3mm white PVC, 6mm white PVC

Table colors:

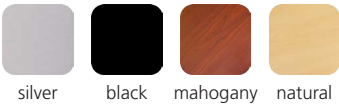

silver

black

mahogany

natural

Parts Included		
Part Label	Qty	Part Code
FABRIC GRAPHIC	x1	WH10-01-G
90 DEGREE ELBOW JOINT FOR 30MM TUBING	x4	TC-30-90
T JUNCTION FOR 30MM TUBING	x6	TC-30-T
4 WAY JUNCTION FOR 30MM TUBING	x2	TC-30-X
R2000MM X 30MM TUBE (997MM ARC)	x9	WH10-01-T1
1114MM X 30MM TUBE	x8	WH10-01-T2

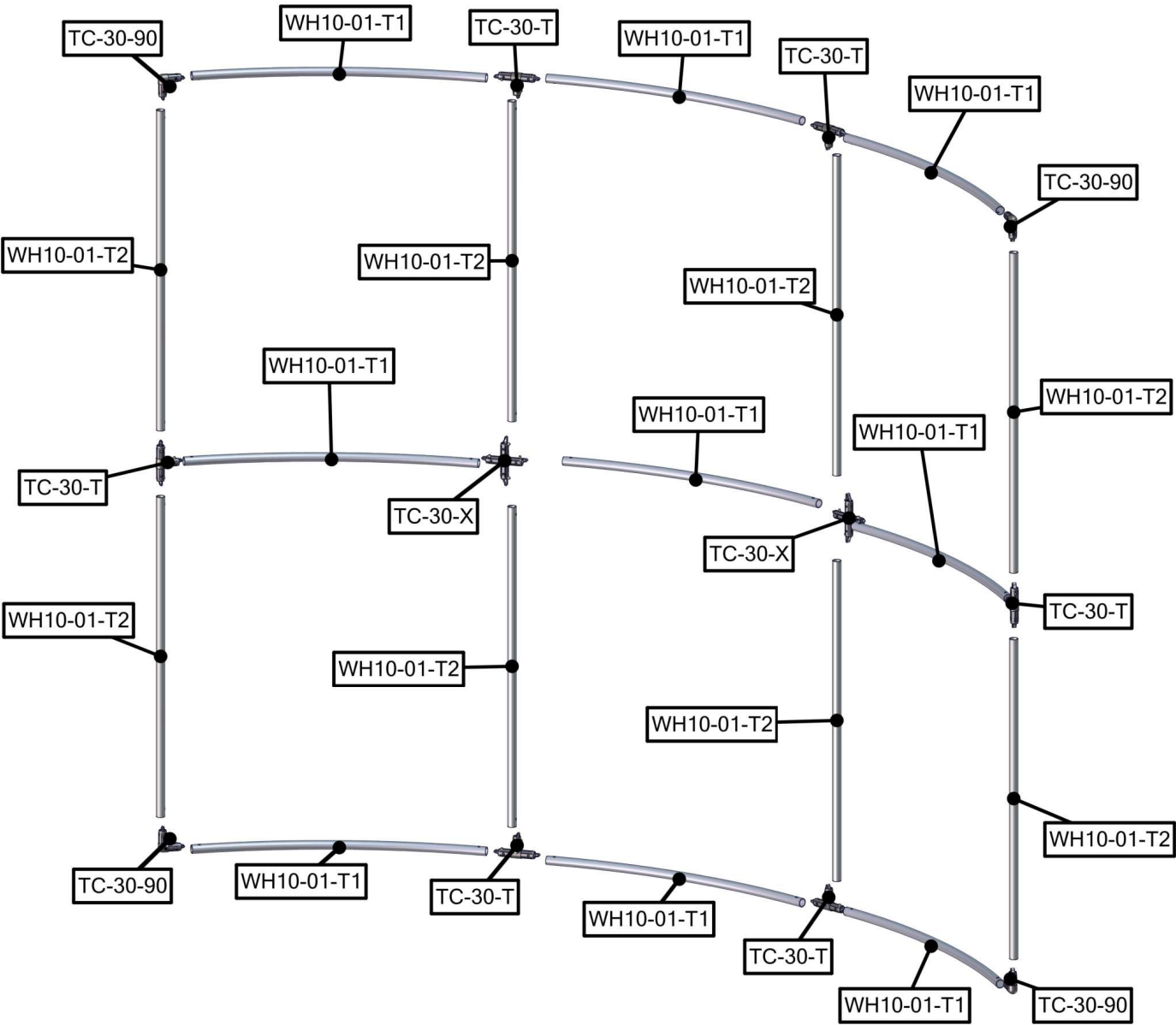

Parts Included		
Part Label	Qty	Part Code
520 X 300 X 30 COUNTER	x1	CTWL03
SILVER ANOXIZE FINISH 30MM TUBE CLAMP	x2	TC-30-30
30MM TUBE SECTION	x2	WL-T3
30MM TUBE SECTION	x1	WL-T12
30MM TUBE SECTION	x1	WL-T1
TOP SINTRA GRAPHIC	x1	WLLH-T-G
BOTTOM SINTRA GRAPHIC	x1	WLLH-G-B

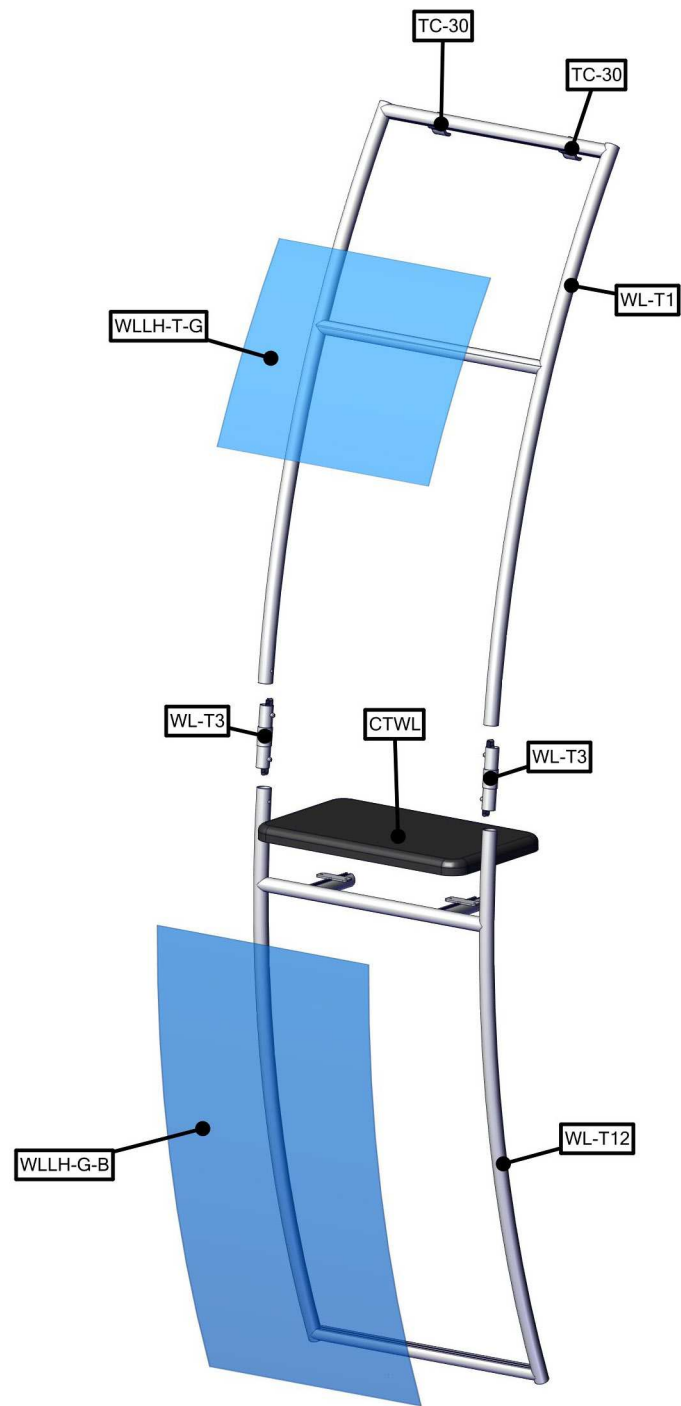

STEP 1: ASSEMBLE FRAME

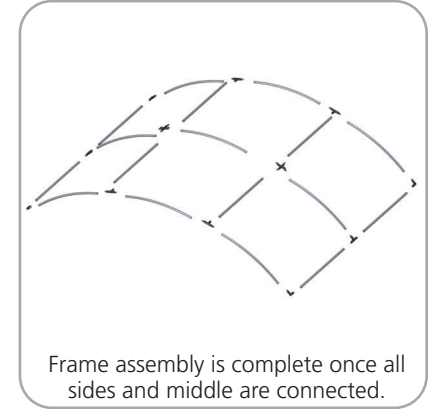
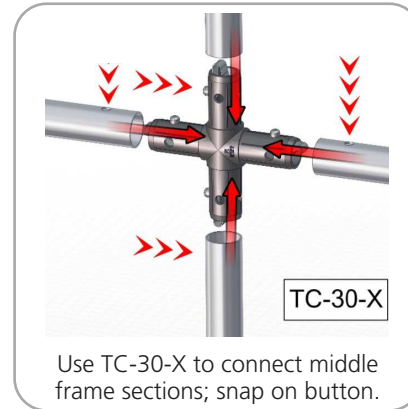
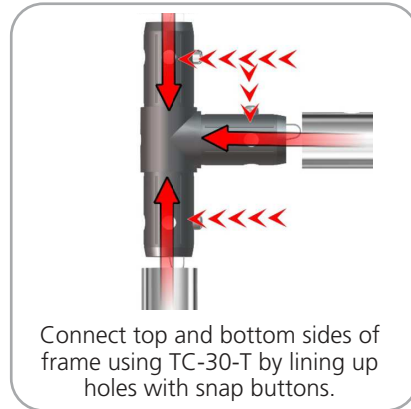
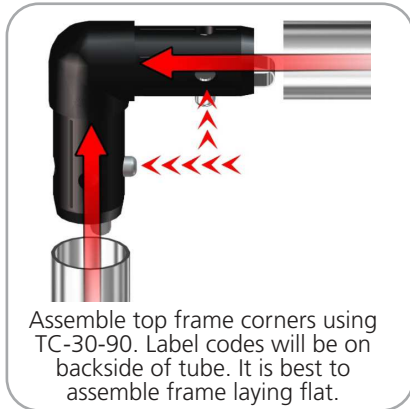

STEP 2: ATTACH GRAPHIC

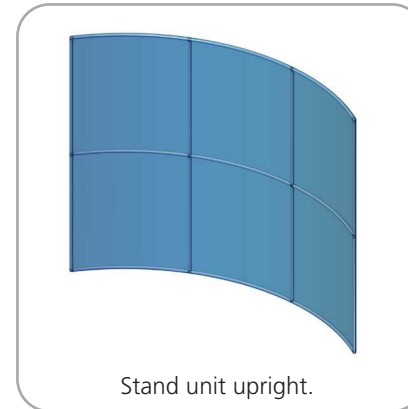
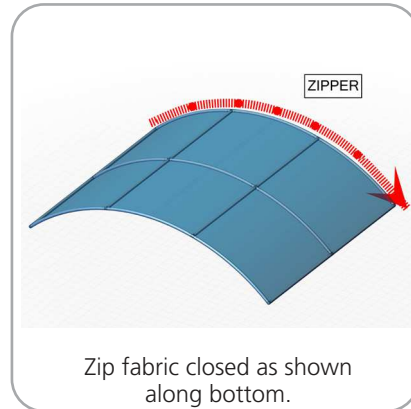
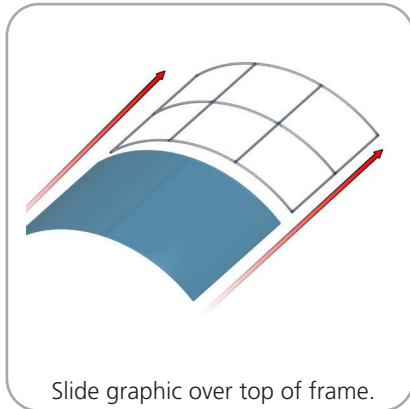

STEP 3: ASSEMBLE LADDER FRAME

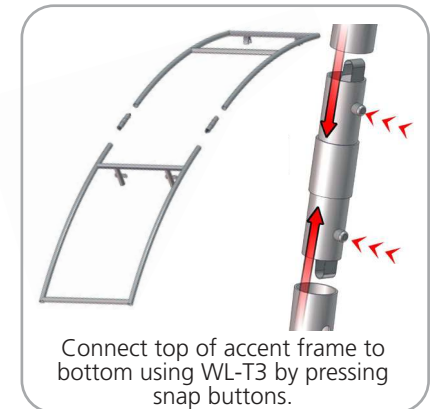

STEP 4: ATTACH COUNTER TO LADDER

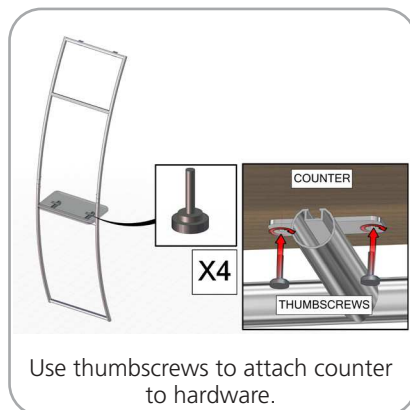

STEP 5: ATTACH GRAPHICS

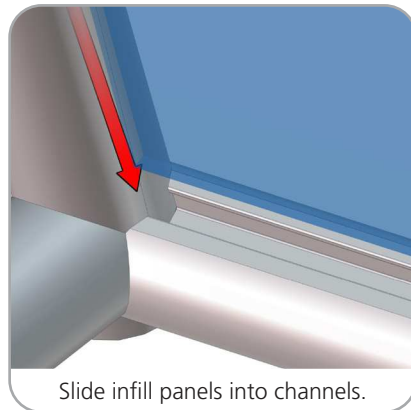

STEP 6: ATTACH TO BACKWALL WITH CLAMPS

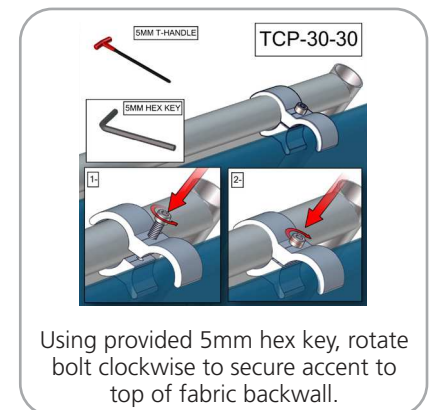
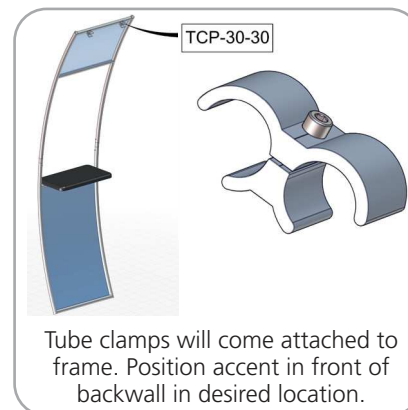

Check out these related products:

The Formulate line is a collection of stylish, ergonomically designed tabletop, 8ft, 10ft, 20ft exhibits, hanging structures, and display accessories. Formulate combines state-of-the-art zipper pillowcase dye-sublimated fabric coverings with a premium lightweight aluminum structure. Formulate is efficient, easy to assemble and disassemble, and offers remarkable style options and choices.

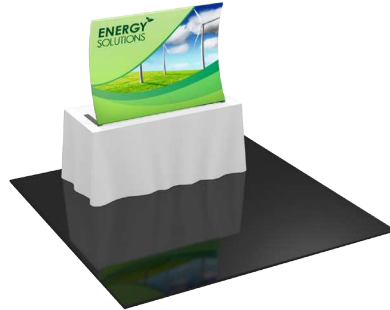

Formulate Tabletops



Formulate 8ft Kits



Formulate 10ft Kits
(Horizontal Curve)



Formulate 10ft Kits
(Vertical Curve)



Formulate 10ft Kits
(Straight)



Formulate 20ft Kits



Formulate Hanging Structures