

Product Specifications

Viewable Graphic Size: 33" w x 36" up to 86" h

**Max Pole Height: 86"

Color: Silver

Footprint Dimensions: 34.25" w x 8.25" d

Graphic Template Available

Product Parts

- 1 - Base
- 2 - Telescoping Pole**
- 3 - Banner Rail
- 4 - Lid
- 5 - Roller w/Snap Rail
- 6 - Tension Wheel
- 7 - Tension Release Button
- 8 - Roller Switch
- 9 - Locking Pin
- 10 - Optional Locking Key

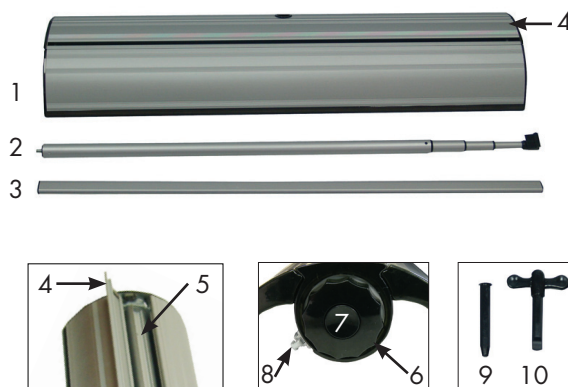

Banner Install

Step 1

Remove all of the product parts from the bag and place, along with the banner, on a clean flat surface. Remove both End Caps (A) from the Banner Rail and snap the Banner Rail (3) open. Fully insert the top edge of the Banner into the groove of the Banner Rail (3) and snap it shut (B). Replace End Caps.

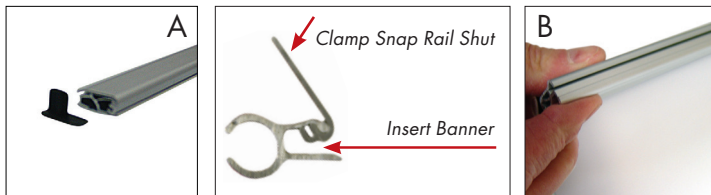

Step 2

Open the Lid (4). Rotate the Internal Roller (5) until the Internal Snap Rail is facing upwards. Insert the Locking Pin (9) into the hole in the side of the Base (1). You will need to rotate the Internal Roller slightly backwards to get the Locking Pin (9) into place.

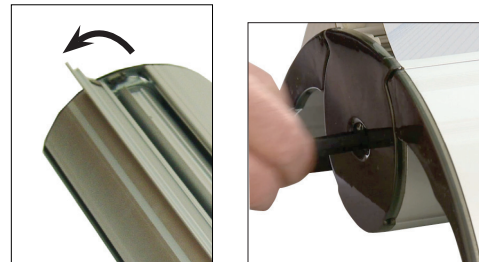

Step 3

Open the Internal Snap Rail (5). Insert the Banner into the groove of the Internal Snap Rail (5) making sure the front of the graphic is facing away from the pole receptacle.



Step 4

Close the Internal Snap Rail (5) and remove the Locking Pin (9).



Banner Install Continued...

Step 5

Press the Roller Switch (8) on the side of the retractor until you hear the roller spring release sound and the Tension Wheel (6) pops out.



Step 6

Turn the Tension Wheel (6) counter clockwise until the banner retracts into the Base (1) on its own. Press the Tension Wheel (6) back into the Base (1).



Banner Display Setup

Step 1

Open Base (1) and set on ground. Insert the Telescoping Pole (2) into the base receptacle and turn clockwise until secure.



Step 2

Lift the Banner Rail (3) up and attach it to the top of the Pole (2).



Step 3

Adjust the height of your Telescoping Pole (2) to your height of your graphic by extending each section. Twist counter clockwise to open the sections. Twist clockwise to lock the sections into place. **Do not exceed 86" high.**



Adjust Tension

Add Tension

Press the Roller Switch (8) so the Tension Wheel (6) pops out. Turn the Tension wheel Counterclockwise.

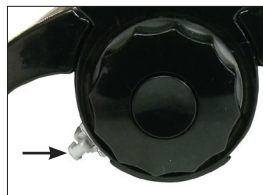

Release Tension

For long term storage you can release the tension on your banner by pressing the Tension Release Button (7) located in the center of the Tension Wheel (6).



Storage

Place all product parts into Carry Case and store in a cool dry location.



Care

To clean, wipe with damp cloth.