

Mightee Mounts

1. (If using graphic with holes) Sandwich graphic in between Mightee Mounts and screw together with wingnuts and carriage bolts (fig. A).
2. (If using graphic without holes) Screw Mightee Mounts together with wingnuts and carriage bolts and rest graphic on top of screws (fig. B).

Applicable Products:

MM12 MM14 MM24
MM36 MM48 MM60

Note:

- Leave 3.25" space on bottom - MM covers that unseen area.
- Holds any rigid substrate up to 1" thick (as long as it holds its own weight).

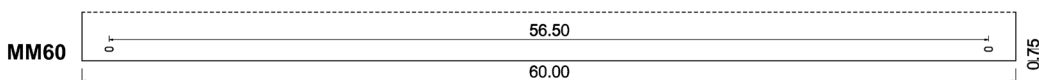
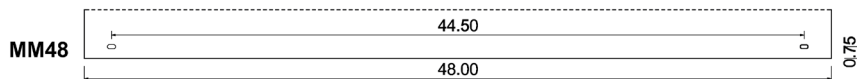
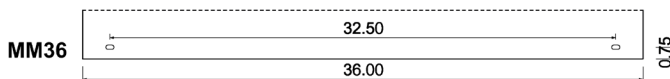
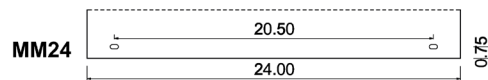
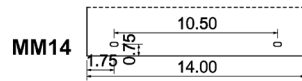
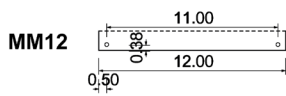
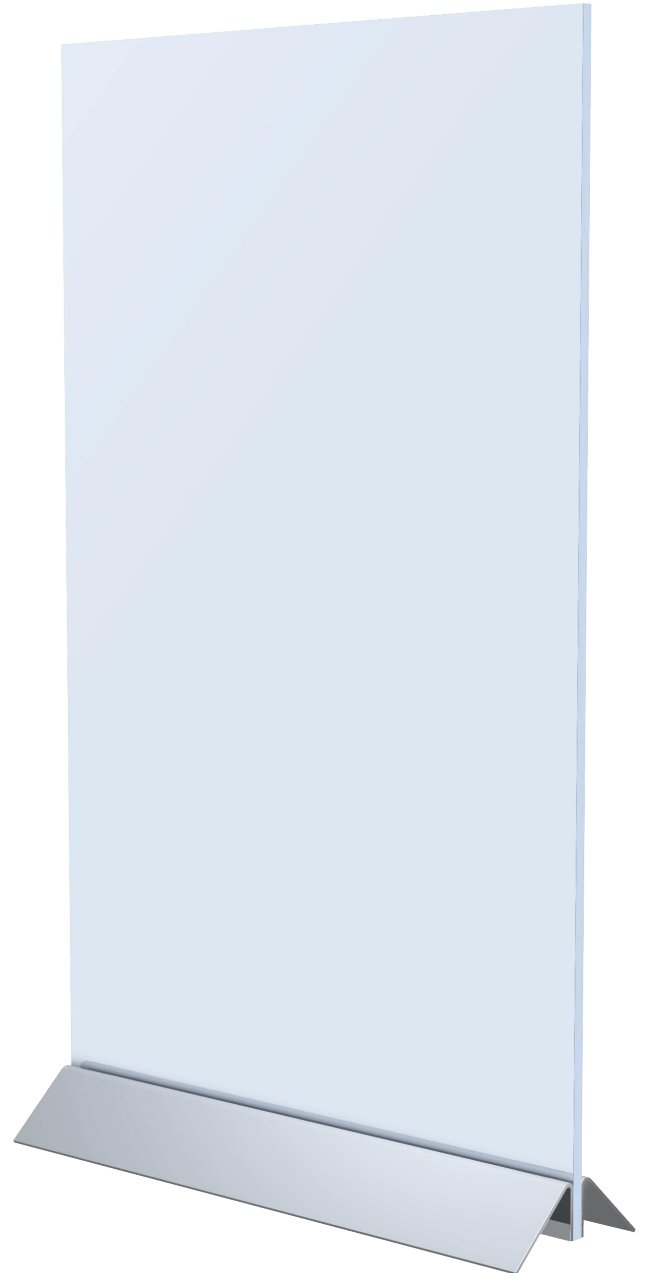
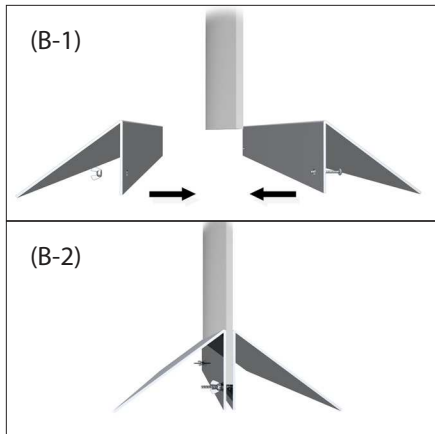
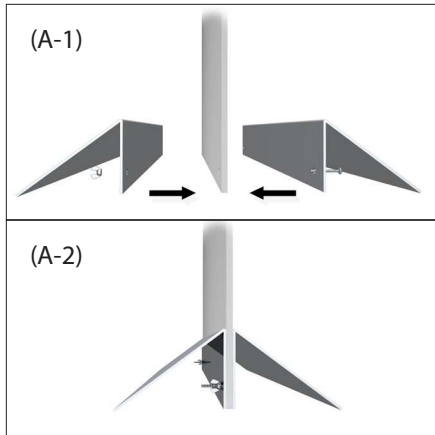

For Graphic Sizing (all dimensions from center hole):
7/32" Holes - MM12
1/4" Holes - MM14, MM24, MM36
MM48, MM60

Note: MM12 uses screws instead of wingnuts/bolts.