

Hybrid Pro Counter 01

HPC-01

All Hybrid Pro™ Modular counters feature accessible storage and locking doors. Purchased printed fabric graphics or rigid infill panels allow for your messaging and branding.



features and benefits:

- Laminate cabinet
- Dye-sub push fit graphic either opaque or backlit
- Locking storage door in back
- Easy step-by-step instructions
- Kit includes laminated cabinet, custom side and top laminated accent panel, locking storage door, one vinyl graphic and one woodcrate case
- Lifetime hardware warranty against manufacturer defects

dimensions:

Hardware	Graphic
<p>Assembled unit: 39.375" w x 39.375" h x 17.75" d 1000.25mm(w) x 1000.25mm(h) x 450.85mm(d)</p> <p>Counter holds max weight 50 lbs / 22.68 kgs</p>	<p>Total visual area: 33.4375" w x 29.5" h</p> <p>Please be sure to include a 2" bleed around the perimeter.</p> <p>Refer to related graphic templates for more information</p>
<p>Shipping</p> <p>Shipping dimensions - ships in 1 case: 1 WOODCRATE case: 47" w x 48" h x 27" d 1219.2mm(l) x 1193.8mm(w) x 685.8mm(h)</p> <p>Approximate shipping weight (entire kit): 301 lbs / 136.5 kgs</p>	

additional information:

Graphic material:
dye-sub graphic either opaque or backlit

Aluminum offsets

Laminate counter color options:

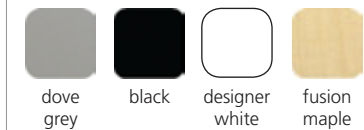

We are continually improving and modifying our product range and reserve the right to vary the specifications without prior notice. All dimensions and weights quoted are approximate and we accept no responsibility for variance. E&OE. See Graphic Templates for graphic bleed specifications.

R-HPC-01-A

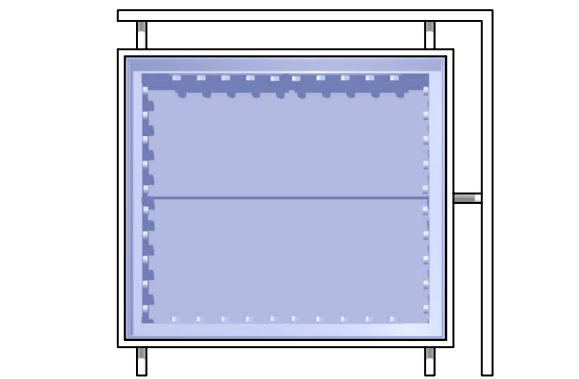
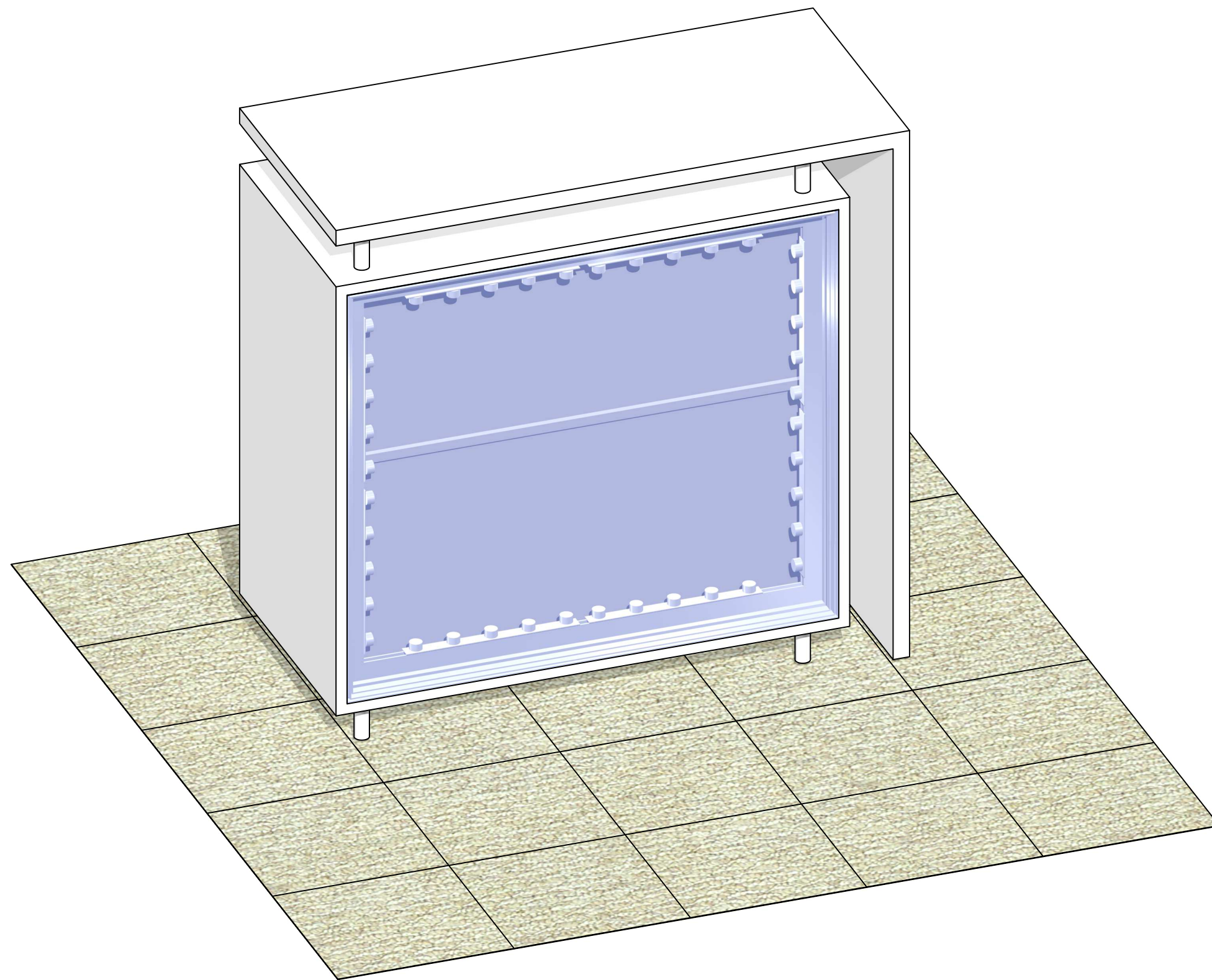

Code	#	Description
R105	2	750MM (29.53") PHFC4 EXTRUSION WITH MITRE CUT BOTH ENDS
R104	2	850MM (33.46") PHFC4 EXTRUSION WITH MITRE CUT BOTH ENDS
R-HPC-01-A-CT	1	4' X 4' X 2' L-SHAPED COUNTER TOP FOR R-HPC-01-A UNIT
SO-3 BARREL	9	1 1/4" X 3" L STANDOFF ASSEMBLY
R-HPC-01-A-CAB	1	4' X 4' X 2' CUSTOM CABINET WITH DOUBLE-DOOR ON BACK (HIDDEN HINGES), 4" SMARTWALL ON FRONT, IN
SS4	4	SILVER SS4 SHELF SUPPORTS
R-HPC-01-A-INT	1	4' X 2' X 5/8" INTERNAL SHELF FOR HPC-01-A
LED-WHT-DB-300	8	300MM (11.81") LENGTH LED LIGHTS FOR DIRECTIONAL BACKLIGHT
GRAPHIC	1	29 1/2" (H) X 33 7/16" (W) BACKLIT DYESUB GRAPHIC W/ FCE-2 (SEG) ON PERIMETER
UNPRINTED	1	29 1/2" (H) X 33 7/16" (W) UNPRINTED W/ FCE-2 (SEG) ON PERIMETER

BOM

R-HPC-01-A

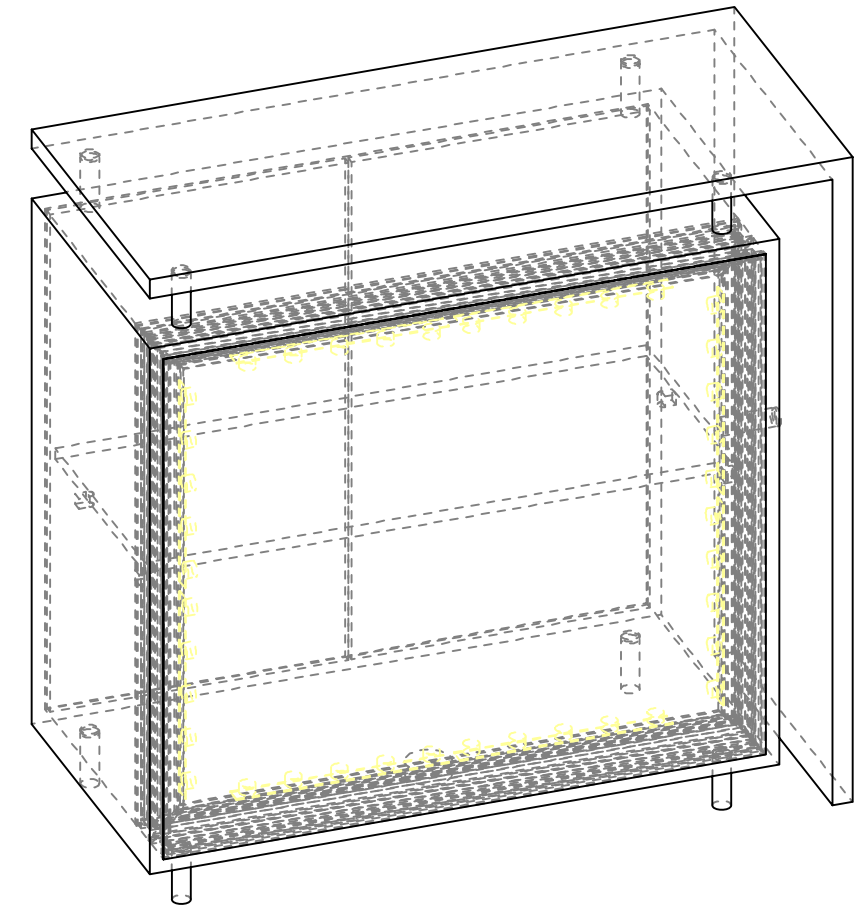
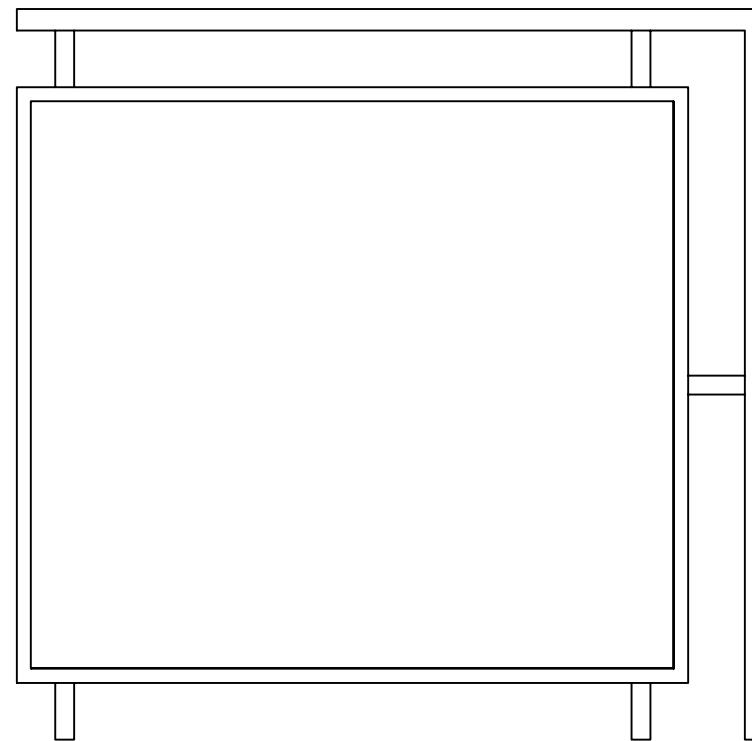
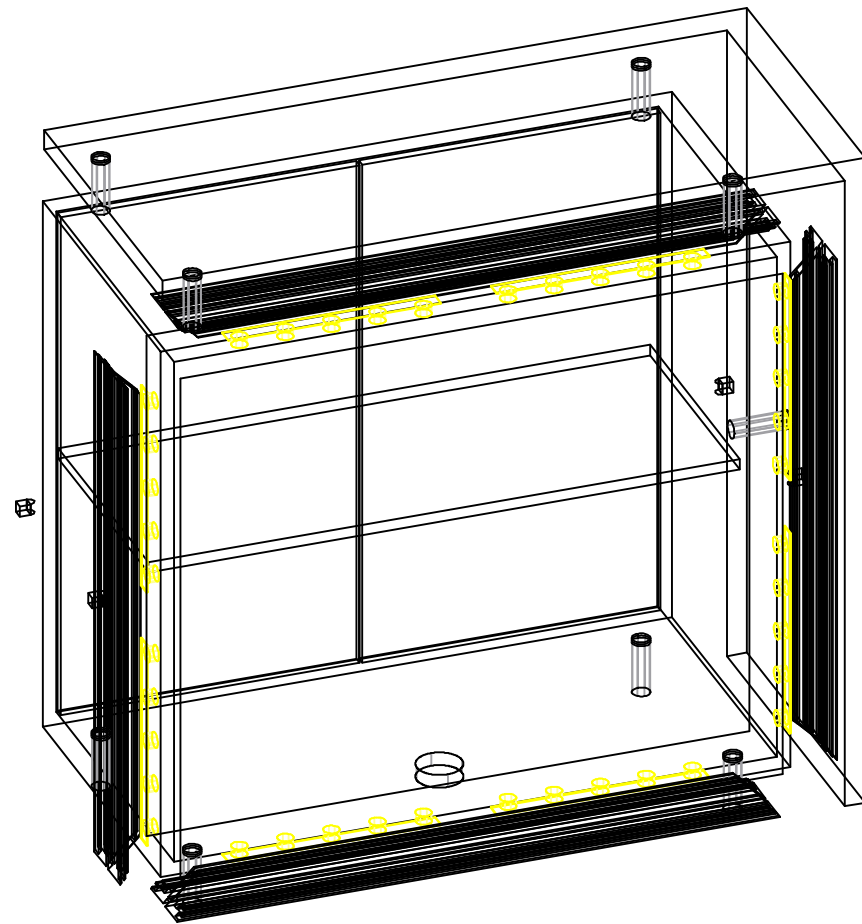
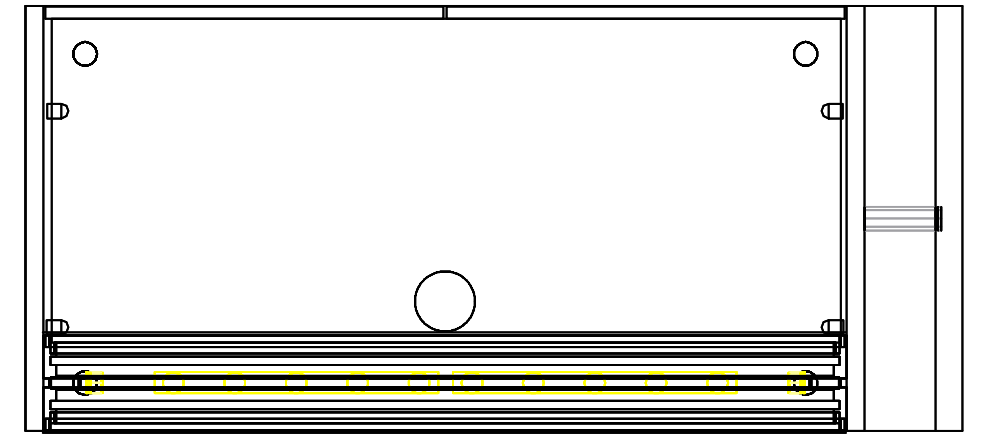

1. Redesign of this exhibit without approval by manufacturer may result in dangerous and unsafe structures. Manufacturer disclaims any responsibility for redesigned exhibits it does not approve in writing.

2. Parts and components such as panels and extrusions are manufactured to metric sizing. Where ever possible sizes have been noted in feet and inches as well as in metric. Below is the imperial to metric sizing table as reference. "Nominal" refers to approximate size.

- | | |
|--------------------|-----------------------------------|
| 2400mm = (94 1/2") | ☒ Phone Line / Fax |
| 2100mm = (82 5/8") | ☒ Internet connection |
| 1800mm = (70 7/8") | ☒ Outlet |
| 1500mm = (59") | ☒ Main Drop (point of distrution) |
| 1200mm = (47 1/4") | |
| 900mm = (35 1/2") | |
| 600mm = (23 5/8") | |
| 300mm = (11 7/8") | |
- Wire running under carpet

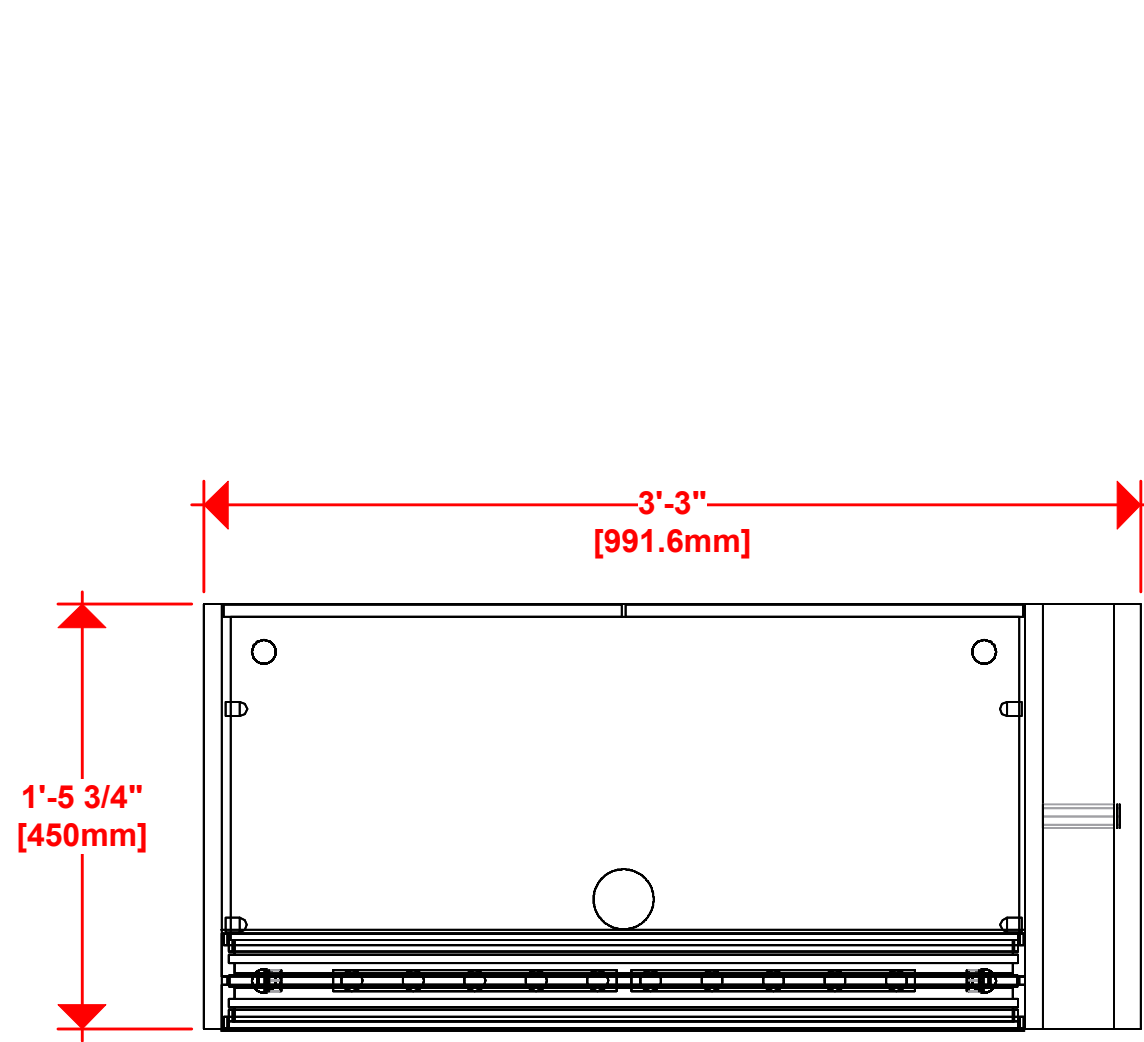

(8) LED LIGHTS = 50W PER STICK

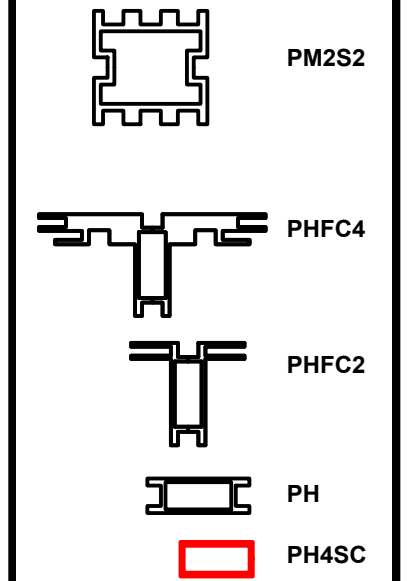
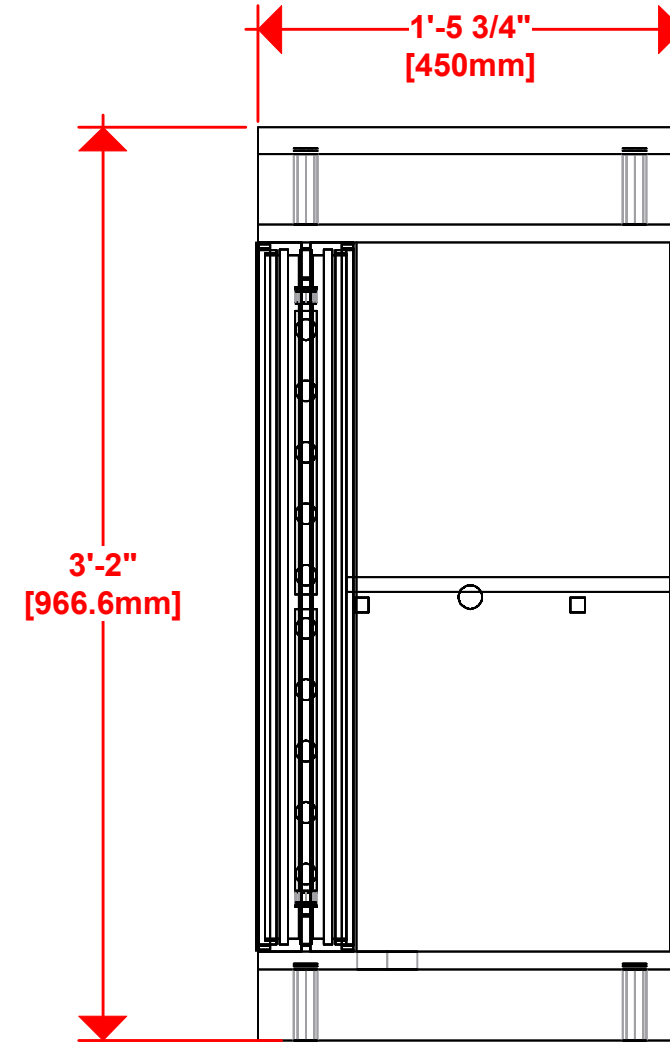

HYBRID PRO RENTAL KIT

Title: SET-UP INSTRUCTIONS

LED-WHT-DB-300 LIGHTS

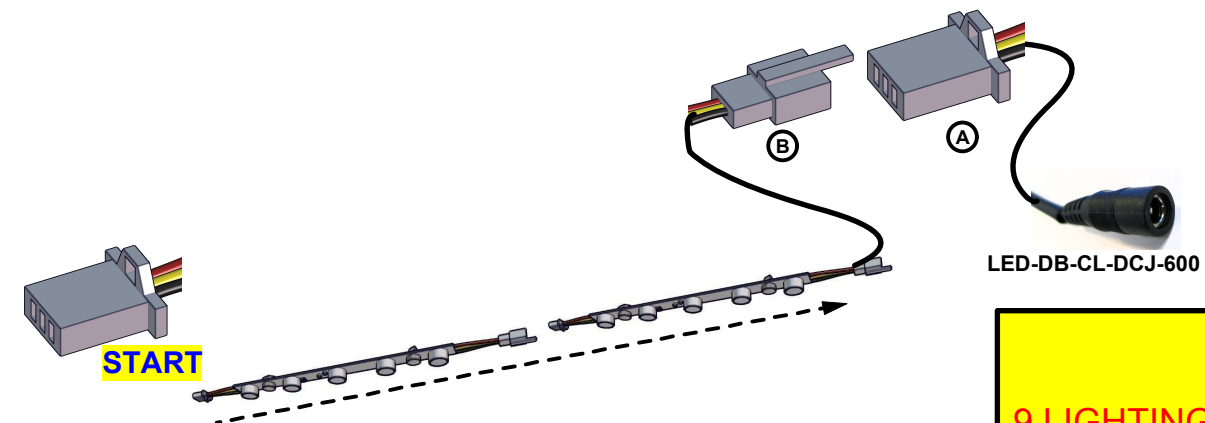
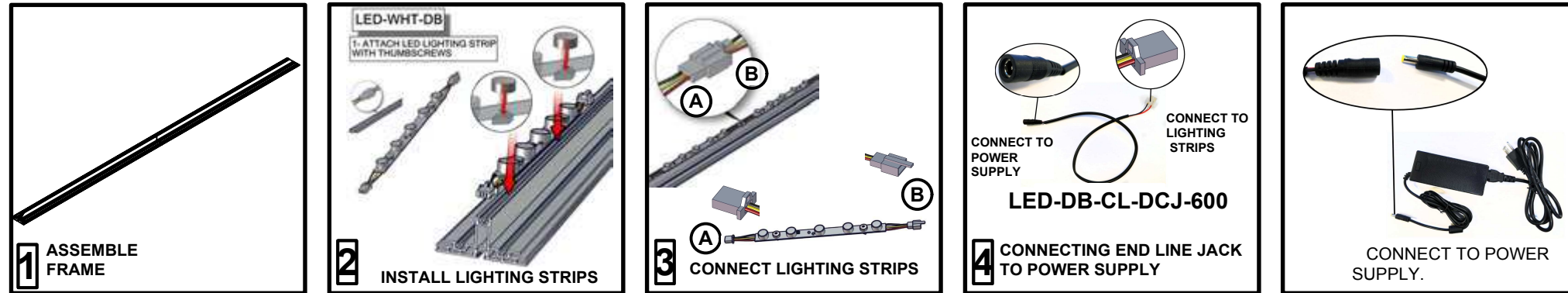

IMPORTANT!
9 LIGHTING STRIPS MAXIMUM
PER POWER SUPPLY

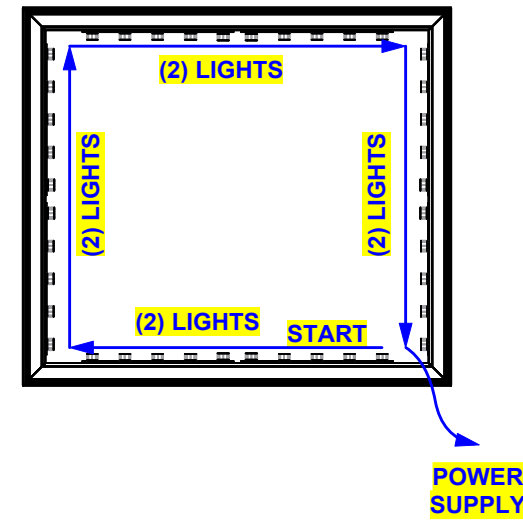

1. Redesign of this exhibit without approval by manufacturer may result in dangerous and unsafe structures. Manufacturer disclaims any responsibility for redesigned exhibits it does not approve in writing.

2. Parts and components such as panels and extrusions are manufactured to metric sizing. Where ever possible sizes have been noted in feet and inches as well as in metric. Below is the imperial to metric sizing table as reference. "Nominal" refers to approximate size.

2400mm = (94 1/2")	Phone Line / Fax
2100mm = (82 5/8")	Internet connection
1800mm = (70 7/8")	Outlet
1500mm = (59")	Main Drop (point of distrution)
1200mm = (47 1/4")	
900mm = (35 1/2")	
600mm = (23 5/8")	
300mm = (11 7/8")	

--- Wire running under carpet

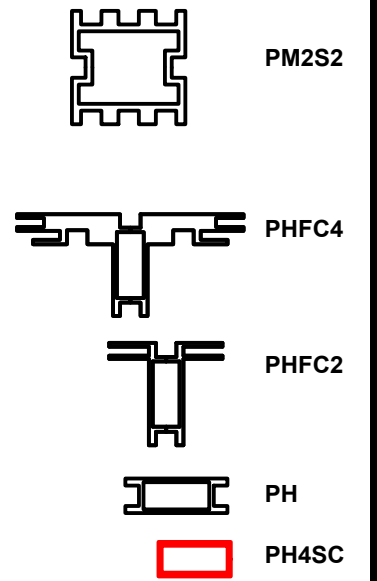

END LINE CONNECTORS & POWER SUPPLY

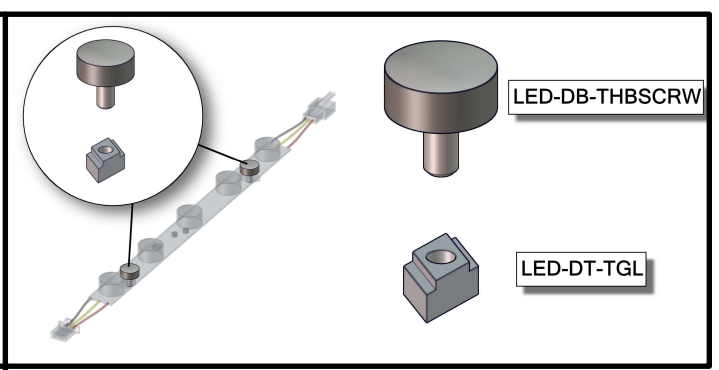
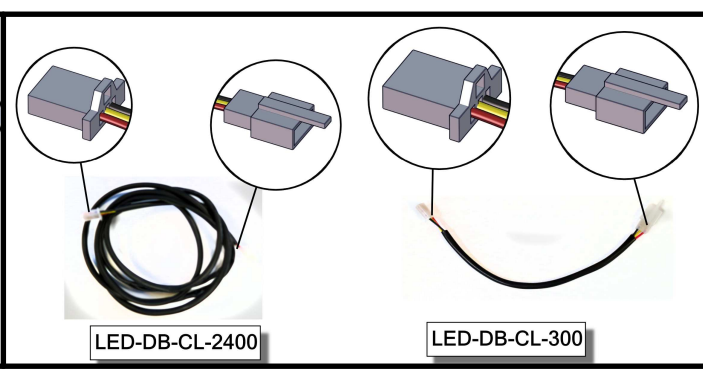
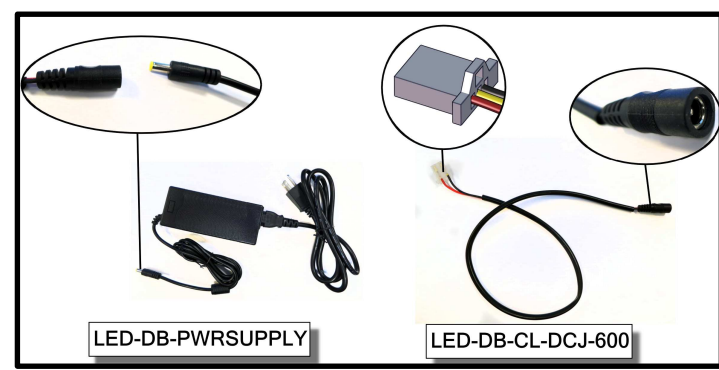

EXTENSION CORDS

HARDWARE

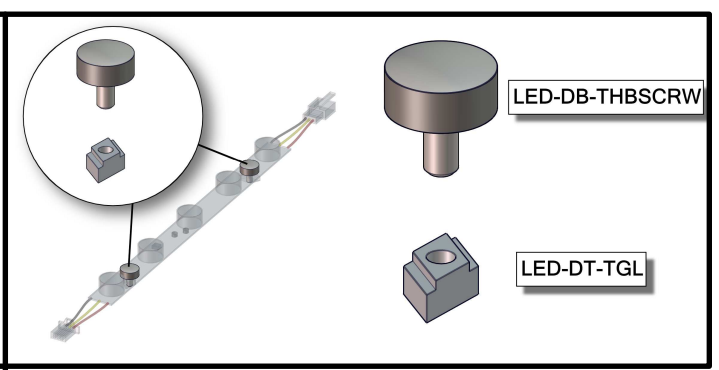

HYBRID PRO RENTAL KIT

Title: SET-UP INSTRUCTIONS

Code	#	Description
R105	2	750MM (29.53") PHFC4 EXTRUSION WITH MITRE CUT BOTH ENDS
R104	2	850MM (33.46") PHFC4 EXTRUSION WITH MITRE CUT BOTH ENDS
LED-WHT-DB-300	8	300MM (11.81") LENGTH LED LIGHTS FOR DIRECTIONAL BACKLIGHT
GRAPHIC	1	29 1/2" (H) X 33 7/16" (W) BACKLIT DYESUB GRAPHIC W/ FCE-2 (SEG) ON PERIMETER
UNPRINTED	1	29 1/2" (H) X 33 7/16" (W) UNPRINTED W/ FCE-2 (SEG) ON PERIMETER

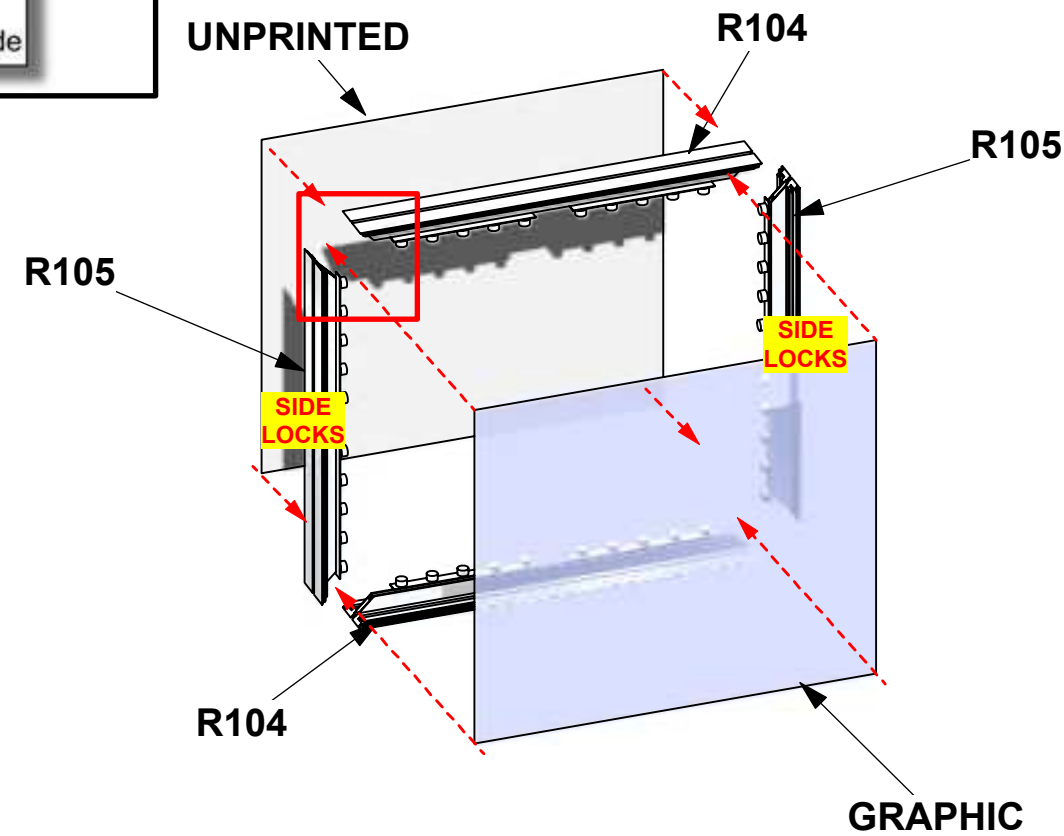
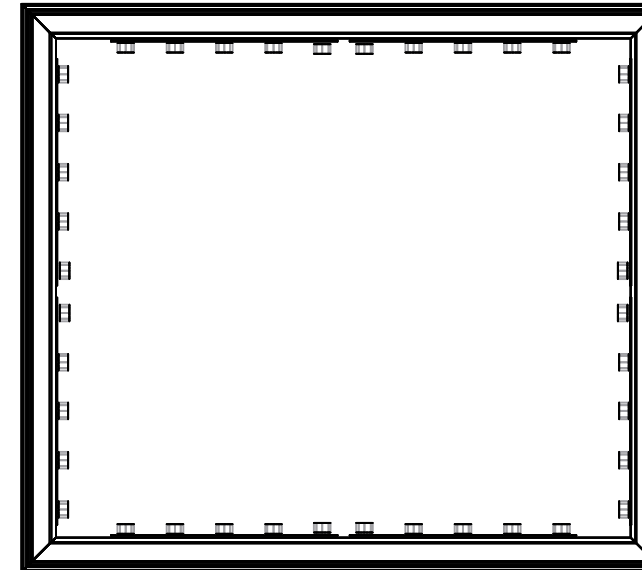
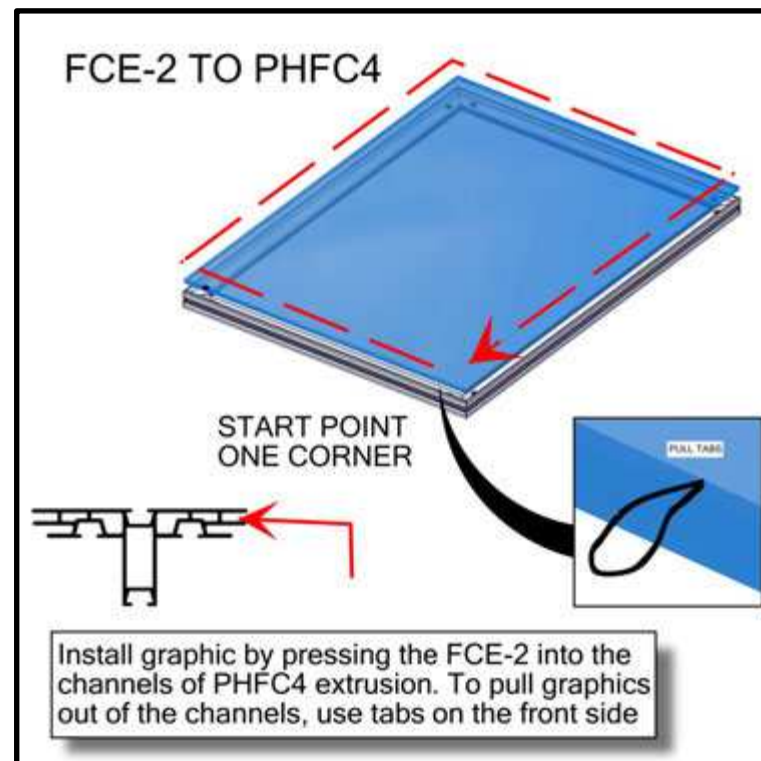
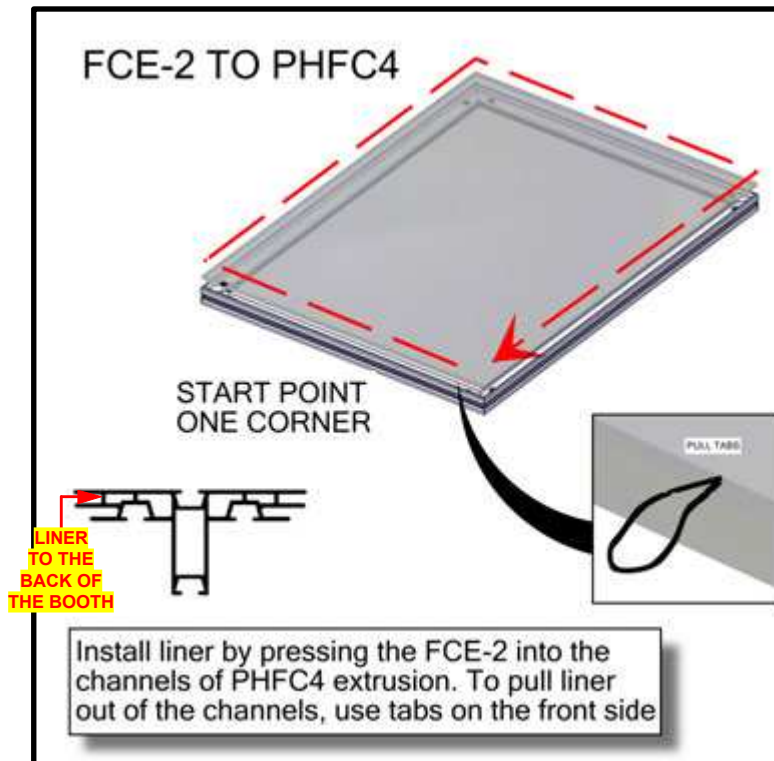
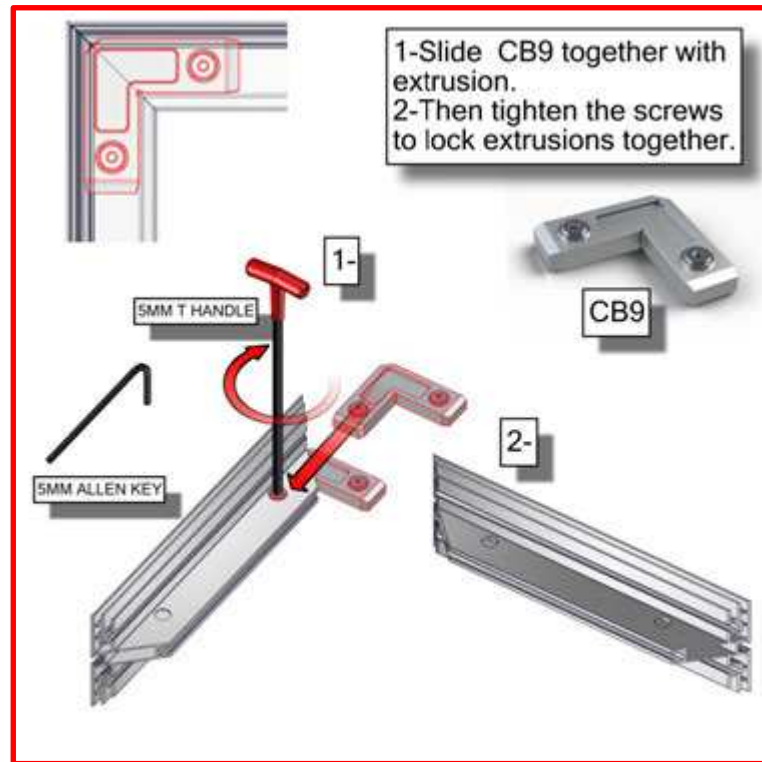

1. Redesign of this exhibit without approval by manufacturer may result in dangerous and unsafe structures. Manufacturer disclaims any responsibility for redesigned exhibits it does not approve in writing.

2. Parts and components such as panels and extrusions are manufactured to metric sizing. Where ever possible sizes have been noted in feet and inches as well as in metric. Below is the imperial to metric sizing table as reference. "Nominal" refers to approximate size.

2400mm = (94 1/2")	Phone Line / Fax
2100mm = (82 5/8")	Internet connection
1800mm = (70 7/8")	Outlet
1500mm = (59")	Main Drop (point of distrution)
1200mm = (47 1/4")	
900mm = (35 1/2")	
600mm = (23 5/8")	
300mm = (11 7/8")	

--- Wire running under carpet

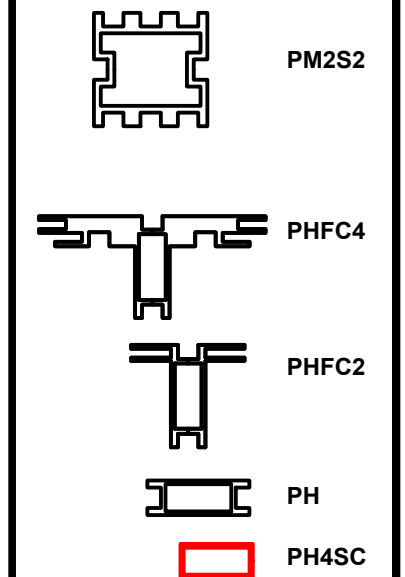

HYBRID PRO RENTAL KIT

Title: SET-UP INSTRUCTIONS

Code	#	Description
SO-3 BARREL	9	1 1/4" X 3" L STANDOFF ASSEMBLY
R-HPC-01-A-CAB	1	4' X 4' X 2' CUSTOM CABINET WITH DOUBLE-DOOR ON BACK (HIDDEN HINGES)

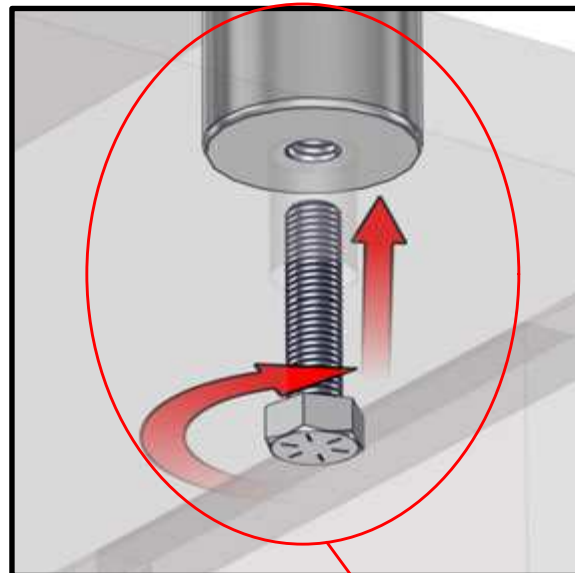

R-HPC-01-A-CAB

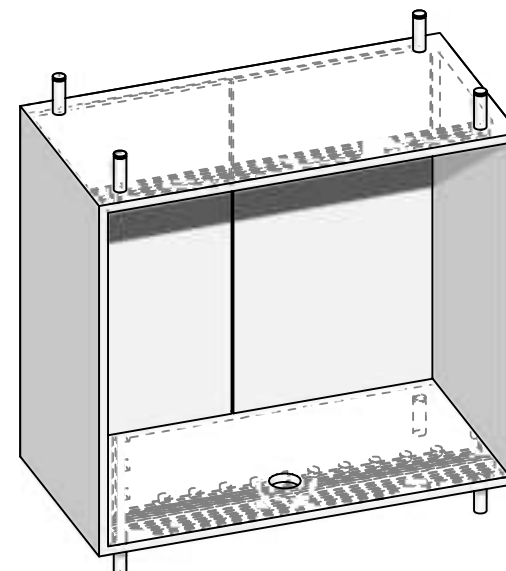
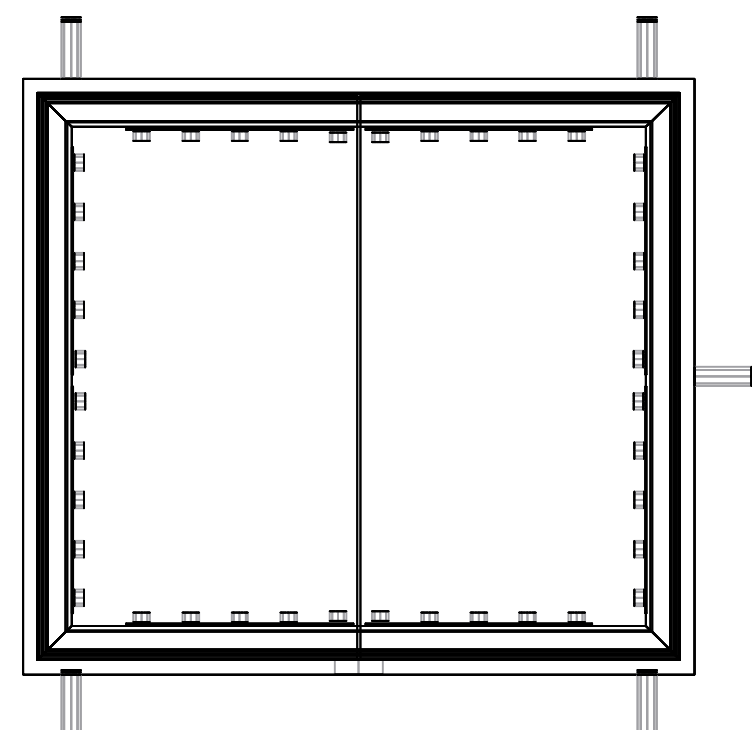
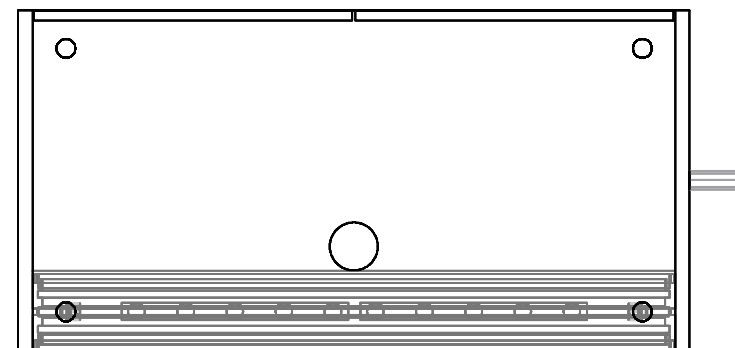
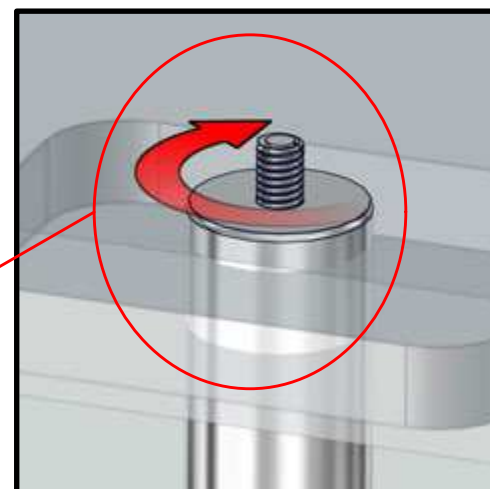
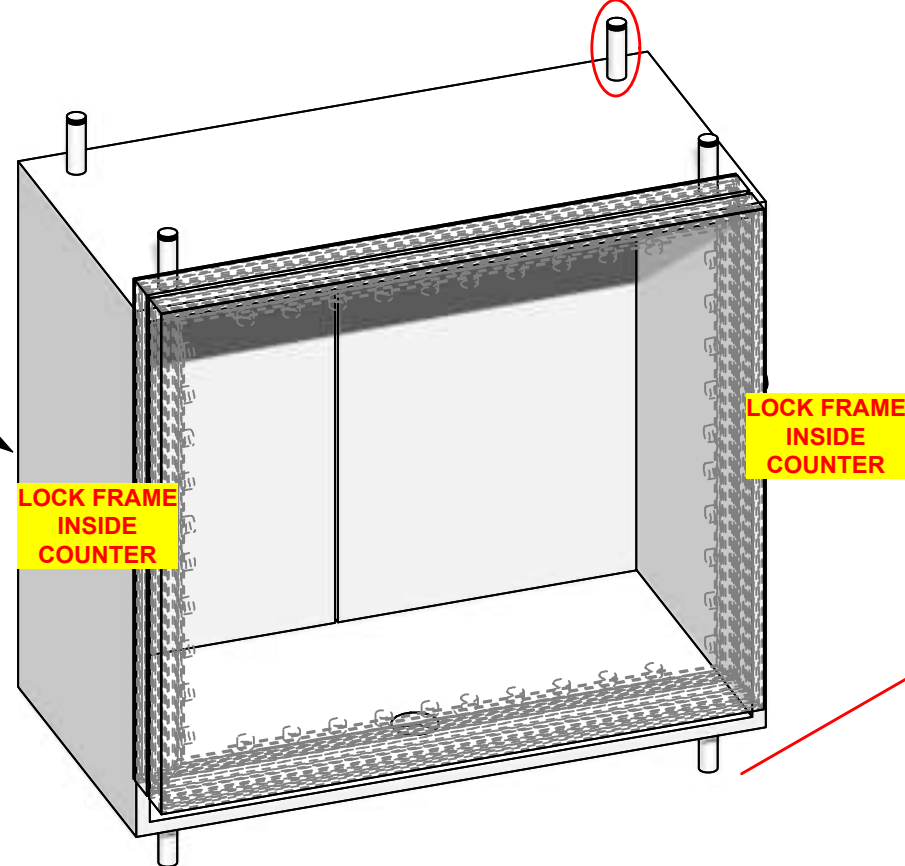

1. Redesign of this exhibit without approval by manufacturer may result in dangerous and unsafe structures. Manufacturer disclaims any responsibility for redesigned exhibits it does not approve in writing.

2. Parts and components such as panels and extrusions are manufactured to metric sizing. Where ever possible sizes have been noted in feet and inches as well as in metric. Below is the imperial to metric sizing table as reference. "Nominal" refers to approximate size.

2400mm = (94 1/2")	Phone Line / Fax
2100mm = (82 5/8")	Internet connection
1800mm = (70 7/8")	Outlet
1500mm = (59")	Main Drop (point of distrution)
1200mm = (47 1/4")	
900mm = (35 1/2")	
600mm = (23 5/8")	
300mm = (11 7/8")	

--- Wire running under carpet

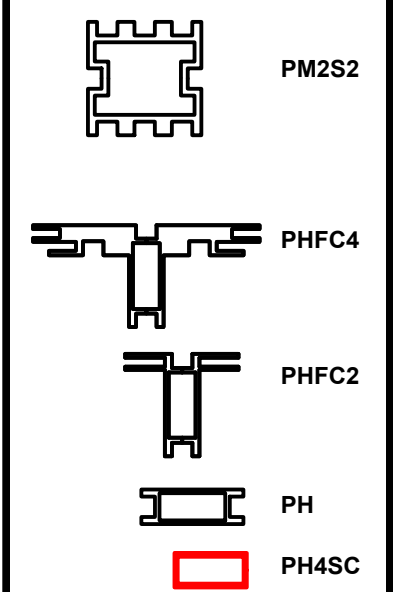

HYBRID PRO RENTAL KIT

Title: SET-UP INSTRUCTIONS

Code	#	Description
R-HPC-01-A-	1	4' X 4' X 2' L-SHAPED COUNTER TOP FOR R-HPC-01-A UNIT
SS4	4	SILVER SS4 SHELF SUPPORTS
R-HPC-01-A-	1	4' X 2' X 5/8" INTERNAL SHELF FOR HPC-01-A

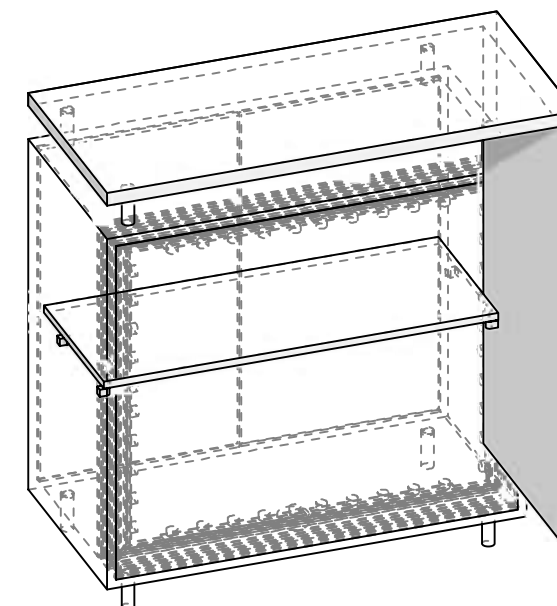
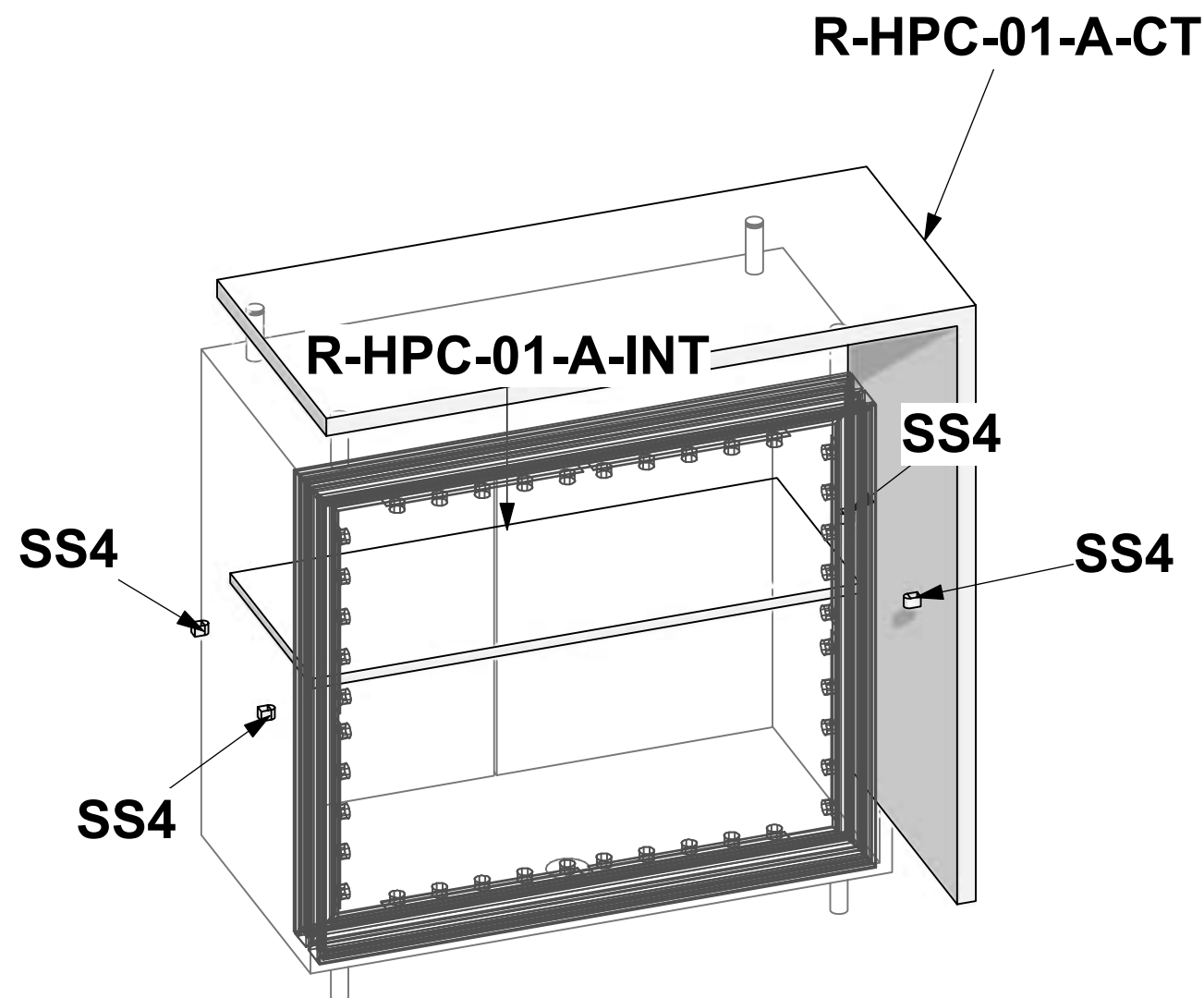
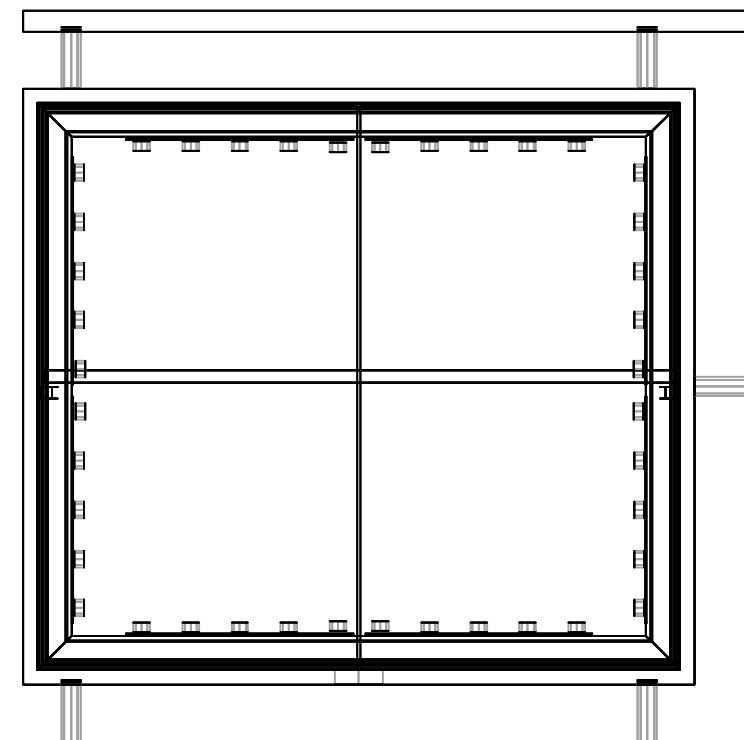
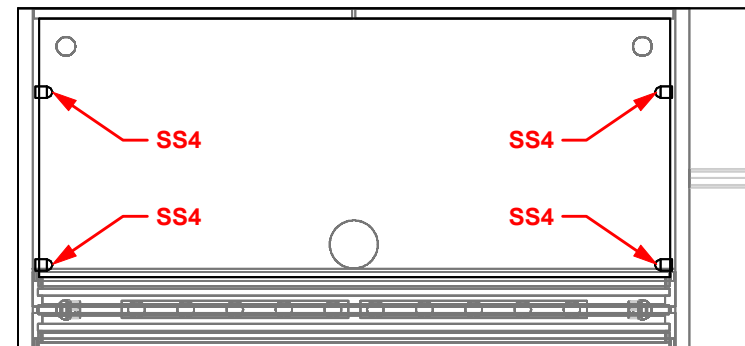
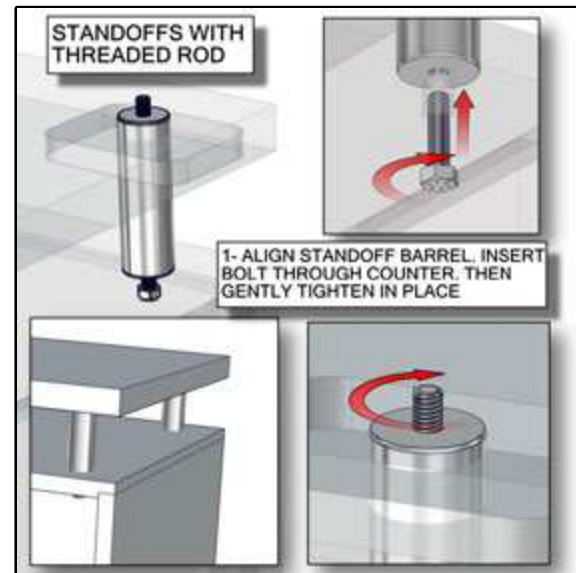
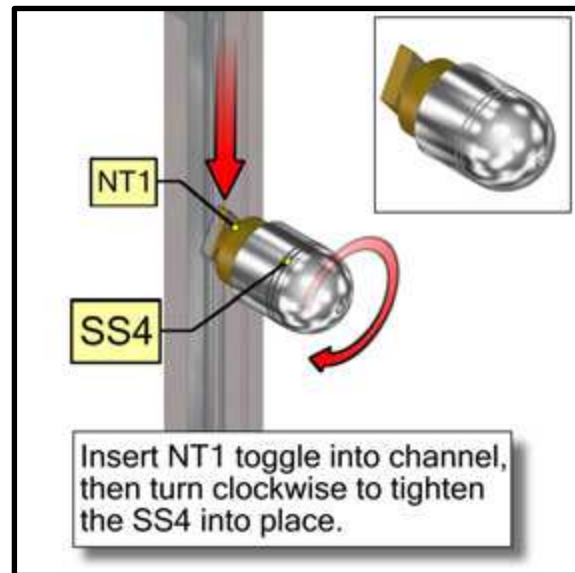

1. Redesign of this exhibit without approval by manufacturer may result in dangerous and unsafe structures. Manufacturer disclaims any responsibility for redesigned exhibits it does not approve in writing.

2. Parts and components such as panels and extrusions are manufactured to metric sizing. Where ever possible sizes have been noted in feet and inches as well as in metric. Below is the imperial to metric sizing table as reference. "Nominal" refers to approximate size.

2400mm = (94 1/2")	Phone Line / Fax
2100mm = (82 5/8")	Internet connection
1800mm = (70 7/8")	Outlet
1500mm = (59")	Main Drop (point of distrution)
1200mm = (47 1/4")	
900mm = (35 1/2")	
600mm = (23 5/8")	
300mm = (11 7/8")	

--- Wire running under carpet

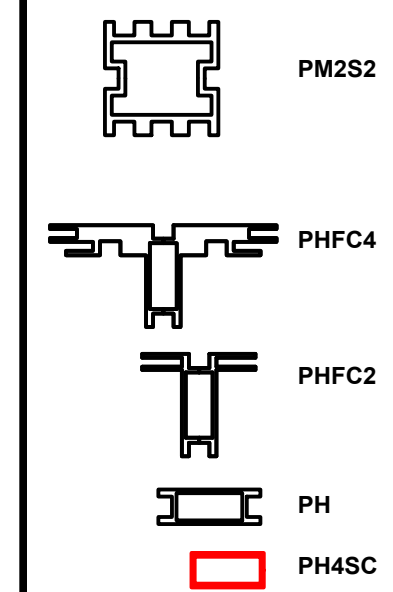

HYBRID PRO RENTAL KIT

Title: SET-UP INSTRUCTIONS





PACKING INSTRUCTIONS



1

1 R-HPC-01-A

CASE # 1

LEGEND	
	GREY FOAM FOLDED TO FILL EMPTY SPACES OR USED AS PROTECTION
	1/8" CARDBOARD SPACER (PUT IN BETWEEN EVERY PANEL)
	DIVIDER
	1/4" WHITE FOAM (USED AS PROTECTION DOOR PANELS W/ LOCKS)



WOODCRATE