

Formulate Accent - 01

FMLT-WL01

Formulate™ accents enhance the functionality of any 10ft or 20ft backwall and add more real estate for messaging too! With monitor supports, literature pockets, shelves, tables, counters and more, you are sure to find the accent that best suits your needs. Side tables and graphic headers also available.

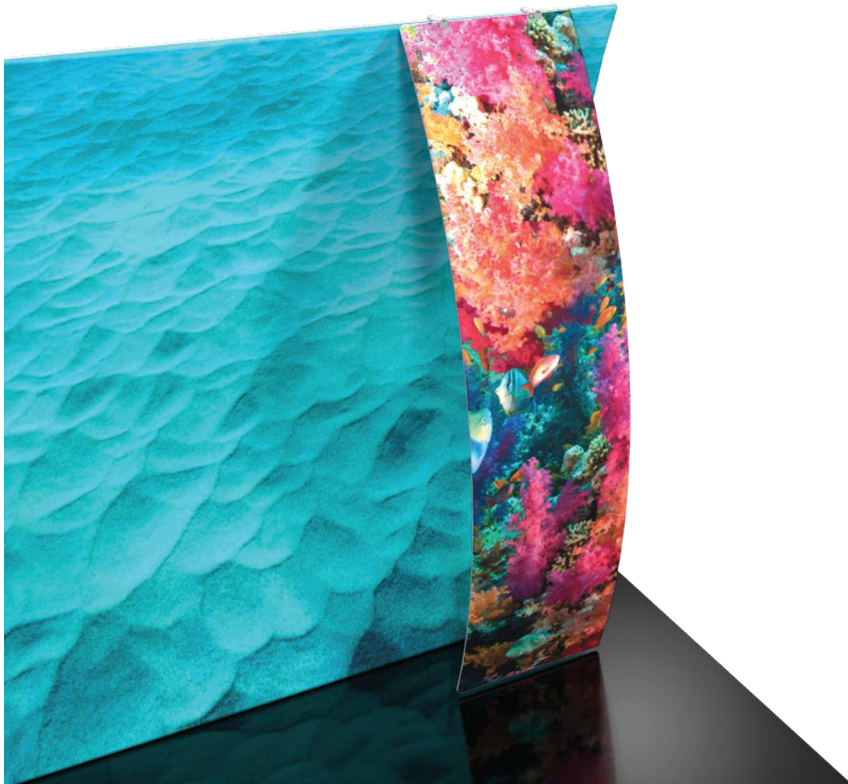

features and benefits:

- State-of-the-art 30mm aluminum tube frame with snap button assembly
- Easy to store and ship
- Quick to assemble and attach to frame
- Kit includes: one frame, one dye-sublimated zipper pillowcase graphic, and one wheeled molded OCL storage case
- Lifetime hardware warranty against manufacturer defects

dimensions:

Hardware	Graphic
<p>Assembled unit: 23.6" w x 92.7" h x 17.7" d 668mm(w) x 2355mm(h) x 450mm(d)</p> <p>Approximate weight (with graphic): 8 lbs / 3.63 kg</p>	<p>Total visual area: 23.6" w x 97" h</p> <p>Please be sure to include 2" bleed around the perimeter.</p> <p>Refer to related graphic template for more information.</p>
Shipping	
<p>Shipping dimensions: 1 OCL case: 19" l x 19" w x 56" h</p> <p>Approximate shipping weight (with case): 29 lbs / 13 kg</p>	

additional information:

Graphic material:
Dye-sublimated zipper pillowcase fabric

We are continually improving and modifying our product range and reserve the right to vary the specifications without prior notice. All dimensions and weights quoted are approximate and we accept no responsibility for variance. E&OE. See Graphic Templates for graphic bleed specifications.

Parts Included – Ladder

Part Label	Qty	Part Code
FABRIC PILLOWCASE GRAPHIC	x1	WL01-G
BACKWALL CONNECT WITH (2) TCH30 BACK TO BACK	x2	TCH30
535MM X 30MM TUBE WITH PART TC-30-T BOTH ENDS	x1	WL01-T1
535MM X 30MM TUBE WITH (2) TC-30-90T	x2	WL01-T2
R2000MM X 30MM TUBE (97MM ARC)	x4	WL01-T3

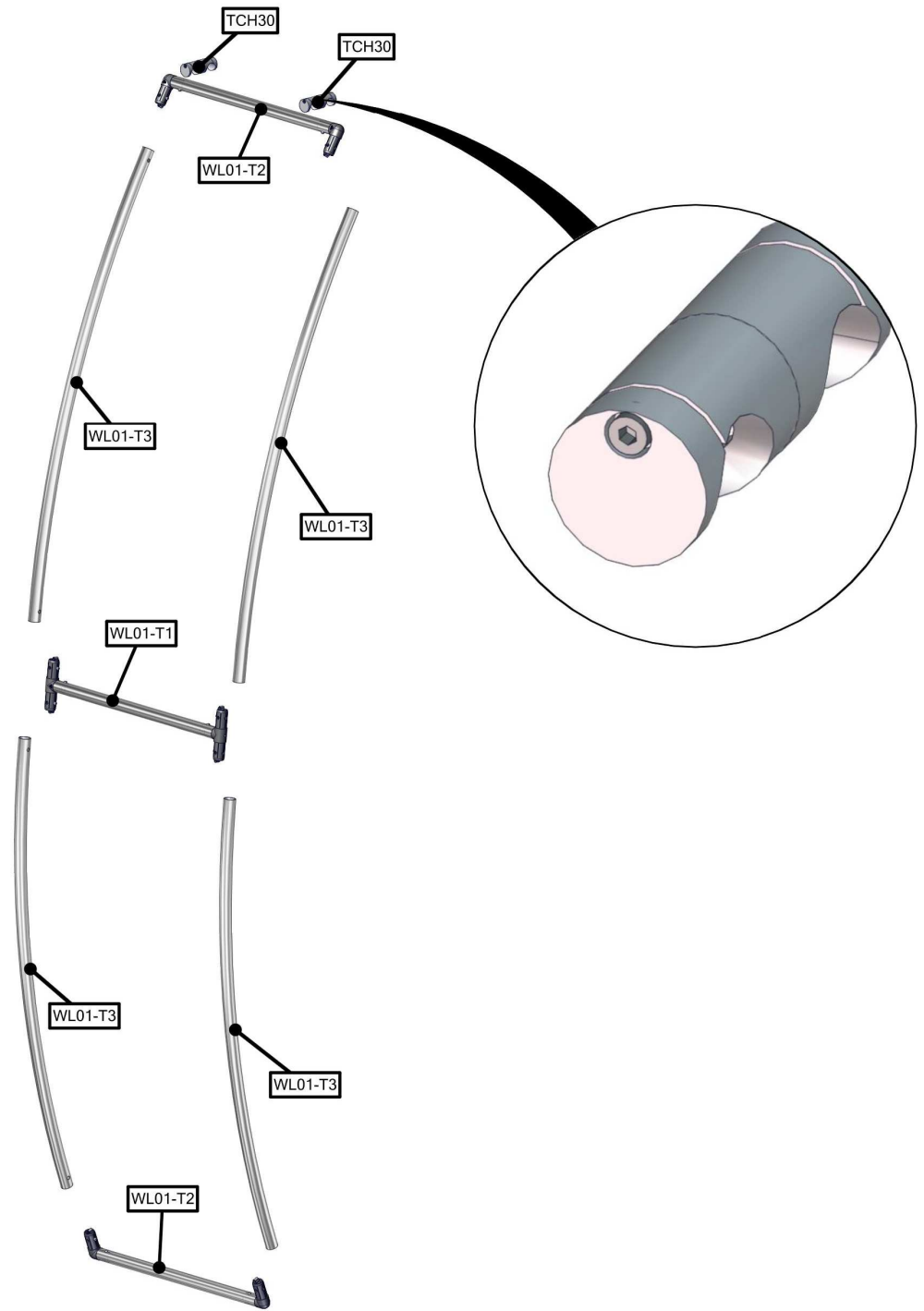
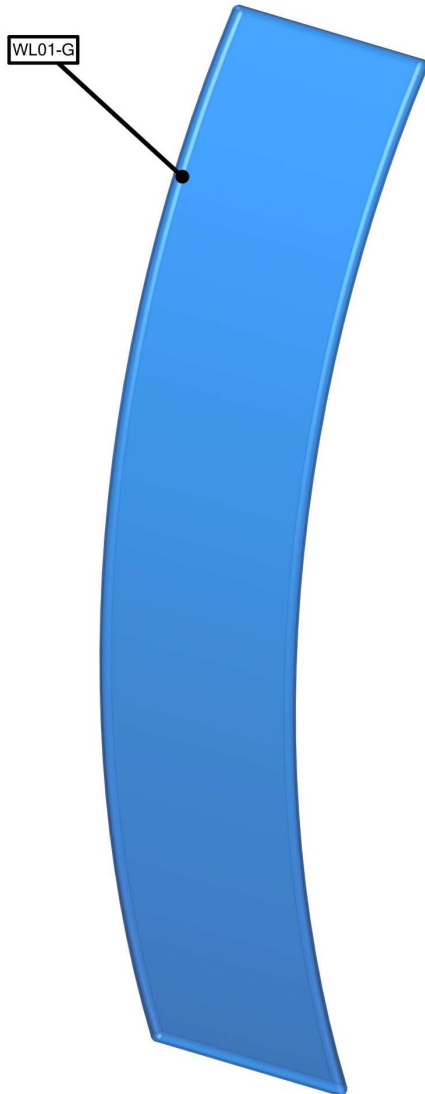

**STEP 1: ASSEMBLE
LADDER FRAME**

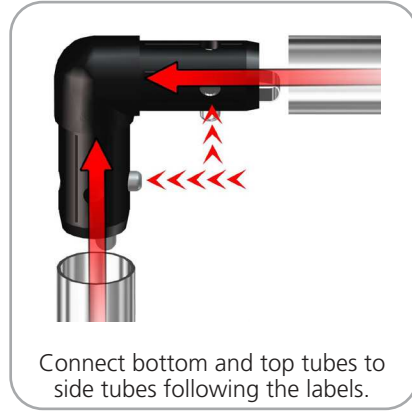
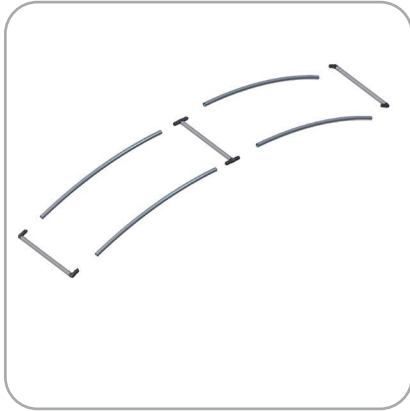

Connect bottom and top tubes to side tubes following the labels.

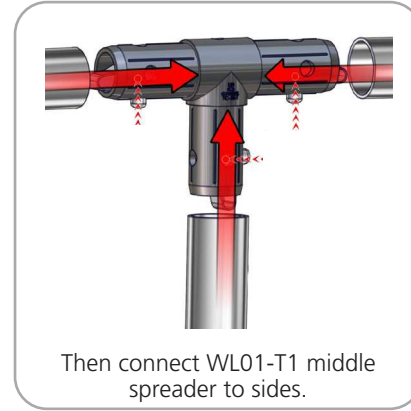

Then connect WL01-T1 middle spreader to sides.

STEP 2: ATTACH GRAPHIC

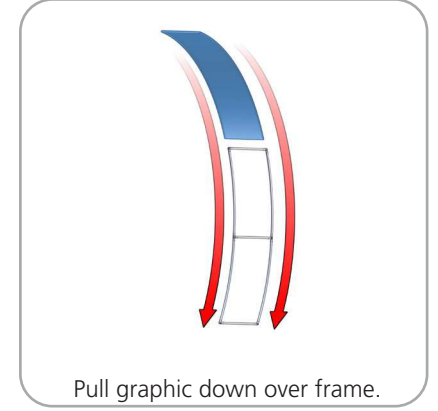

Pull graphic down over frame.

**STEP 3: ATTACH TO
BACKWALL WITH CLAMPS**

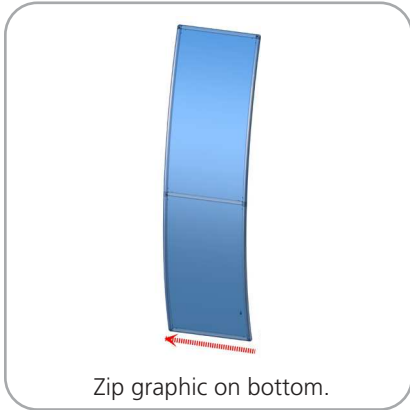

Zip graphic on bottom.

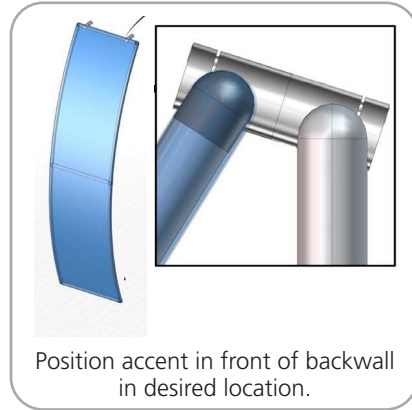

Position accent in front of backwall in desired location.

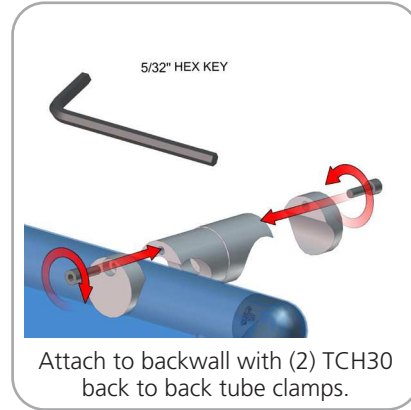

Attach to backwall with (2) TCH30 back to back tube clamps.



Unit is complete.